

iHome®

Model: **iP18**
Color Changing
Dual Alarm Clock Speaker
for Your iPhone / iPod

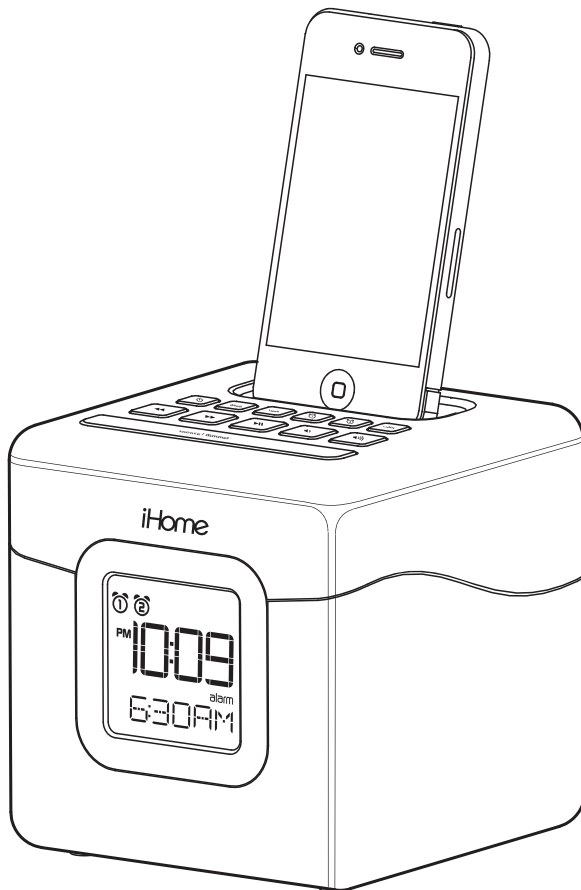

works with



iHome Sleep
alarm clock app



iHome Radio
internet radio app



download QR code
reader app and scan



Questions? Visit www.ihomeaudio.com

Download from Www.Somanuals.com. All Manuals Search And Download.

Table of Contents

Controls and indicators -----	1
iP18 Quick Start -----	2
Display / Installing/Replacing the Clock Backup Battery -----	3
Setting the Time Using Time Sync / Setting the Time Manually / Setting the Alarm -----	4
Operating the Alarm / Playing and Charging your iPhone/iPod -----	5
Color Change Mode / Dimmer Mode / Bedtime Sleep Mode -----	6
A Consumer Guide to Product Safety -----	7
Trouble Shooting -----	8
Warranty Information -----	9

Maintenance

- Place the unit on a level surface away from sources of direct sunlight or excessive heat.
- Protect your furniture when placing your unit on a natural wood and lacquered finish. A cloth or other protective material should be placed between it and the furniture.
- Clean your unit with a soft cloth moistened only with mild soap and water. Stronger cleaning agents, such as Benzene, thinner or similar materials can damage the surface of the unit.

Getting Started

Thank you for purchasing the iHome iP18 Color Changing Dual Alarm Clock Radio for your iPhone or iPod. Designed specifically to work with your iPhone or iPod, this system provides high quality audio performance combined with relaxing colored mood lights. Please read this instruction carefully before operating the unit and keep it for future reference.

Note: iHome Sleep and iHome Radio apps are not covered in detail in this booklet. To learn more about how these apps can enhance your experience, please download the free iHome Sleep app from the App Store and review the Start Guide.

FCC Information

This device complies with Part 15 of the FCC Rules, operation is subject to the following two conditions: (1) This device may not cause harmful interference, and (2) this device must accept any interference received, including interference that may cause undesired operation.

- Warning: Changes or modifications to this unit not expressly approved by the party responsible for compliance could void the user's authority to operate the equipment.
- NOTE: This equipment has been tested and found to comply with the limits for a Class B digital device, pursuant to Part 15 of the FCC Rules.

These limits are designed to provide reasonable protection against harmful interference in a residential installation. This equipment generates, uses and can radiate radio frequency energy and, if not installed and used in accordance with the instructions, may cause harmful interference to radio communications.

However, there is no guarantee that interference will not occur in a particular installation. If this equipment does cause harmful interference to radio or television reception, which can be determined by turning the equipment off and on, the user is encouraged to try to correct the interference by one or more of the following measures:

- Reorient or relocate the receiving antenna.
- Increase the separation between the equipment and receiver.
- Connect the equipment into an outlet on a circuit different from that to which the receiver is connected.
- Consult the dealer or an experienced radio/TV technician for help.

This Class B digital apparatus complies with Canadian ICES-003.

Cet appareil numérique de la classe B est conforme à la norme NMB-003 du Canada.

Battery Information

For models that use Lithium batteries

- Lithium batteries can explode or cause burns if disassembled, shorted, recharged, exposed to water, fire, or high temperatures. & not handled appropriately
- Do not place loose batteries in a pocket, purse, or other container containing metal objects, mix with used or other battery types, or store with hazardous or combustible materials.
- Store in cool, dry, ventilated area.
- Follow applicable laws and regulations for transport and disposal.

Controls and Indicators

Top panel

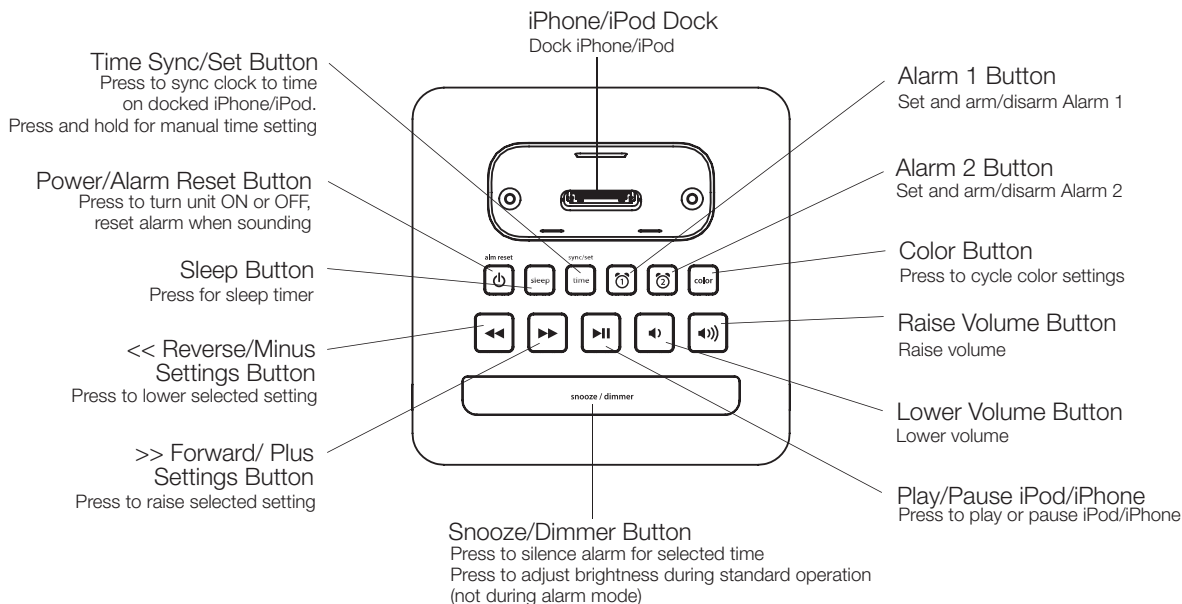

Back panel

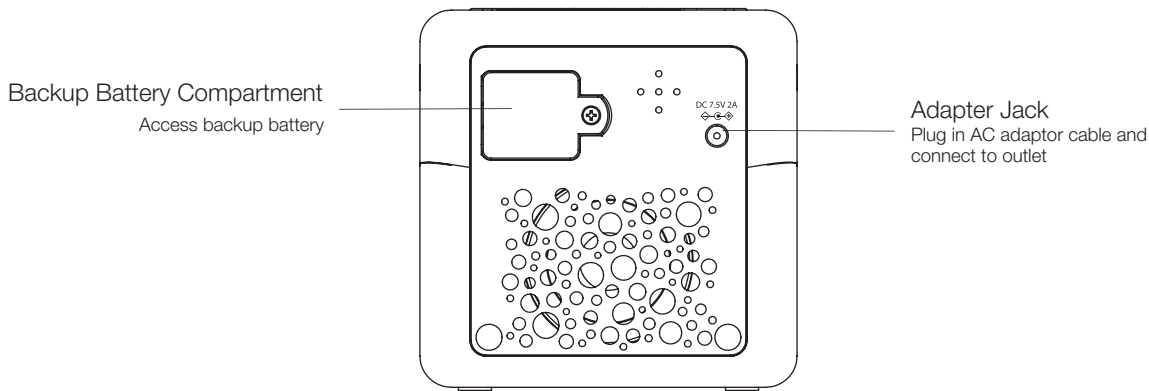

iP18 Quick Start

1: power

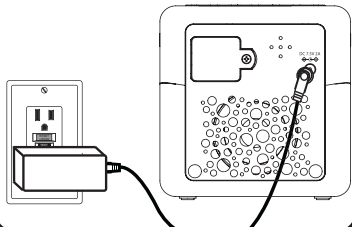

Attach AC adaptor cable to adaptor jack on back of the iP18 and plug the other end into a wall socket to play and charge iPhone/iPod. Remove the tab from the battery backup compartment.

2: inserts

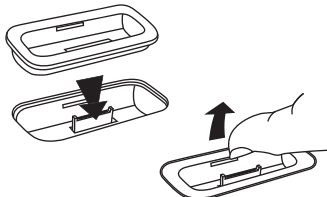

Select the dock insert for your iPhone/iPod model from the table below and place insert in dock. To remove insert, place thumbnail in slot and gently pull upwards.

3: auto sync

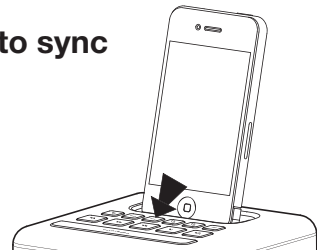

Insert your iPhone/iPod on to the dock. After a moment the unit will attempt to Auto Sync the clock on the unit to the time on your iPhone or iPod. "SYNC AUTO" will appear on the display, followed by "SYNCED" and 2 beeps. If "FAIL" appears and a long beep sounds, try again with a different iPhone/iPod or set time manually (see page 4).

Use this insert

iPod touch 2G
insert 16

iPhone 4
insert 19

nano 6G/touch 4G
insert 20

For this
iPhone / iPod

iPod touch 2G/3G

iPhone 4

nano 6G/
iPod touch 4G

Note: An insert provides the best stability and safety for your iPhone/iPod, but you can safely dock your iPhone or iPod without an insert, provided you always do so with care. If you prefer to use an insert and don't have one for your model, please visit www.ihomeaudio.com or call iHome toll free at 800-288-2792 to purchase one.

4: iPhone/iPod

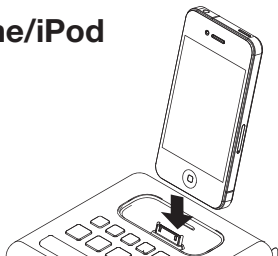

Dock a playing iPhone or iPod to turn on the unit. After a moment you will hear your music. Press the **▶|| Button** to play a docked iPhone or iPod. Press the **▶|| Button** again to pause play. Your iPhone or iPod will charge while docked.

5: color change

LED
GLOW

Press and release the **Color Button** as needed to cycle through color mode settings. In *Fast* color change mode, press and release the **Color Button** when a specific color is showing to select that color.

Display

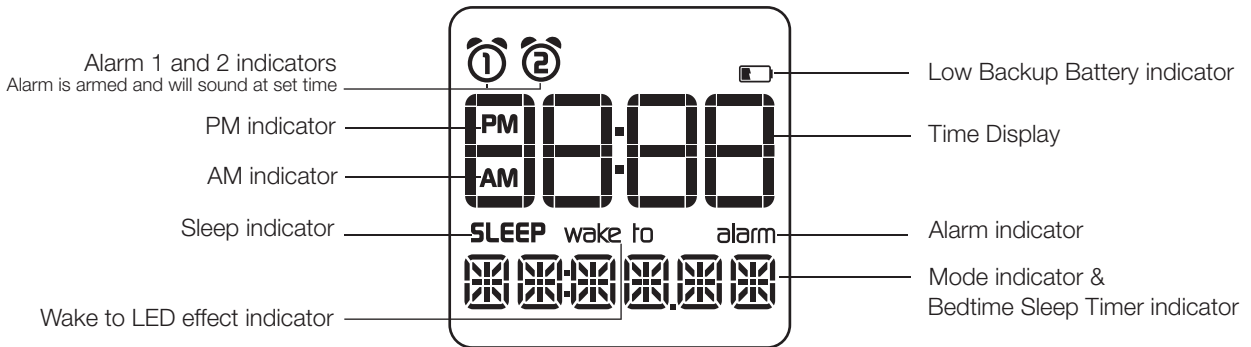

Installing/Replacing the Clock Backup Battery

Note: The CR2450 lithium battery is included in the unit. Please pull out the battery pull tab before you use the unit. This model is equipped with a battery backup circuit that will maintain the time and alarm time settings in the event of a temporary power interruption. The battery backup circuit will also operate the buzzer alarm to wake you up at the selected wake up time even if the power is out. The battery backup circuit requires one CR2450 lithium battery, included.

When the backup battery is getting weak the Low Backup Battery Indicator will begin flashing in the display. When you see this flashing indicator you should replace the backup battery as soon as possible. Purchase a replacement CR2450 battery, available wherever batteries are sold, and follow steps 1 through 4 below to install the replacement battery.

To replace the backup battery:

IMPORTANT: When replacing the backup battery be sure to have the unit connected to the AC outlet to maintain all of your settings, otherwise it will be necessary to reset the time and alarm time after the battery is replaced.

1. Place unit face down. Locate the battery backup compartment found on the back of the unit.
2. Use a Phillips screwdriver to open the battery compartment cover. Remove the cover and remove the exhausted CR2450 battery.
3. Insert a fresh CR2450 battery in the backup battery compartment with the "+" side facing up, as illustrated.
4. Replace the battery compartment cover and screw the compartment door back in place. Do not overtighten. Confirm that the backup battery indicator is not flashing in the display.

Note: Make sure you dispose of battery properly (see your local regulations).

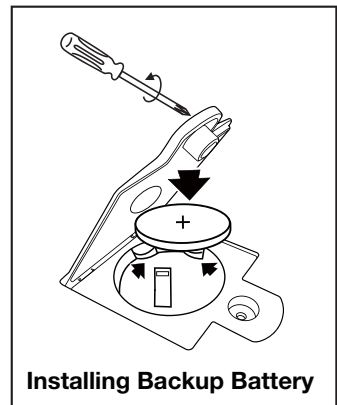

Setting the Time Using Time Sync

The Time Sync feature allows you to sync the time setting on the unit to the time from your iPhone or recent model iPod (iPod touch, iPod nano and iPod Classic; older iPod models such as iPod mini do not support this feature). By default, the unit will attempt to *Auto Sync* whenever an iPhone or iPod is docked. You can turn off auto sync if you prefer to manually sync the time at any time using the steps below.

1. *Press and hold* the **Time Sync/Set Button** on top of the unit until “SET Auto” flashes. Press the **<<** or **>>** **Button** to select “Set manual”. Auto Sync is disabled, and syncing must now be done manually. (To reset for Auto Sync, select “SET Auto”).
2. Gently dock your iPhone or iPod.
3. Press and release the **Time Sync/Set Button**. “SYNC” flashes in the display, indicating sync attempt. If sync is successful, the time will update and you will hear two beeps and the display will show “SYNCED”.
4. If sync does not work, a long beep will sound and “FAIL” will appear on the display. If this happens, try using a different iPhone/iPod to attempt syncing again or set time manually (see below).

NOTE: The iPhone is constantly updated to current time via cell phone towers. The time on your iPod is only accurate to the last time it was synced to a computer. It's possible to have up to 59 seconds difference between the unit and synced iPhone/iPod.

Setting the Time Manually

1. *Press and hold* the **Time Sync/Set Button** until “SET Auto” flashes. Press the **<<** or **>>** **Button** to select “Set manual”.
2. Press and release the **Time Sync/Set Button**. The time will flash. Press the **<<** or **>>** **Button** to set the correct hour (press and hold for rapid setting). Remember to set the correct AM or PM time. The AM and PM Indicators are located to the left of the time digits.
3. Press either the **⌚** or **🕒** **Button** at any time during clock setting to toggle the display between 24 hour (military) and 12 hour (standard) display mode. The PM indicator will not appear when display is in 24 hour mode.
4. Press the **Time Sync/Set Button** again. The year will flash. Press the **<<** or **>>** **Button** to set the correct year.
5. Press the **Time Sync/Set Button** again. The date will flash. Press the **<<** or **>>** **Button** to set the correct date (press and hold for rapid setting).
6. Press the **Time Sync/Set Button** again (or no button press within 10 seconds) to exit the clock setting mode. 2 beeps will confirm clock setting is complete.

Setting the Alarms

This unit has a dual alarm system so you can set two separate alarms to different alarm times.

Setting the Alarms

Note: Alarm 1 and Alarm 2 are set the same way; **Alarm Button** below means the button (**⌚** or **🕒**) for whichever alarm you are setting.

1. Press and hold the **⌚** or **🕒** **Button** until the alarm time flashes on the lower part of the display. Press and release the **<<** or **>>** **Button** to set the alarm time (press and hold for faster setting). Remember to set the correct AM or PM time.
2. Press and release the **Alarm Button** again to confirm the set alarm time. If the unit does not detect an iPhone or iPod at the set alarm time, the unit will default to buzzer alarm. The alarm cycle lasts for one hour; make sure you have enough music on your iPhone or iPod to last that long.
3. Press and release the **Alarm Button** again, then press and release the **<<** or **>>** **Button** to set the color LED wake cycle: Dawn (amber fade leading up to alarm time), Flash (flashing red while alarm sounds), Glow (glowing color sequence while alarm sounds) or None (no wakeup LED effect).
4. Press and release the **Alarm Button** again (or no button within 10 seconds) to exit the alarm setting mode. The alarm will be armed once set and the corresponding alarm icon will light up. The lower part of the display will show the earliest set alarm time.

Operating the Alarm

At the set time, the alarm will sound for 1 hour. If waking to iPhone or iPod, make sure your playlist has an hour of music in it.

1. To turn off the sounding alarm and reset it to come on at the same time the following day, press and release the **⏻ Button**. The alarm sound will stop but the alarm icon will remain in the display, indicating the alarm is armed. To turn off the alarm without resetting it for the next day, press and release the **Alarm Button**.
2. Press and release the **Alarm Button** during normal operation (alarm is not sounding) to view the currently set alarm time. Press and release again as needed to arm the alarm (alarm icon is present) or to cancel it (no alarm icon).
3. Press and release the **Snooze Button** while alarm is sounding to temporarily silence the alarm for the set snooze time (default is 9 minutes). To adjust the snooze time: Press and hold the **Snooze Button** during normal operation. The snooze time will flash on the display. Press the **<<** or **>>** **Button** to adjust the snooze time from 1 - 29 minutes. Press and release the **Snooze Button** again (or no button within 10 seconds). Two beeps will sound to confirm snooze setting and return unit to normal operation.

Playing and Charging your iPhone/iPod

1. Gently dock playing iPhone or iPod. The unit will turn on and in a moment you will hear your music. When docked, the iPhone or iPod will charge until fully charged.
Note: If the volume is too low on the iPhone/iPod, the unit may not detect that the iPhone/iPod is in play mode. Press and release the **▶|| Button** to play it.
2. Press the **<<** or **>>** **Button** to go to the next or previous track; press and hold to scan forwards or backwards within a currently playing track.
3. When the iPhone/iPod is docked and in standby mode, press the **▶|| Button** to play it.
4. When the iPhone or iPod is in play mode, press the **▶|| Button** to pause play; press again to resume play.
5. Press the **◀|** or **▶|)** **Button** to adjust the unit volume.
6. To turn off the unit, press and release the **⏻ Button**. Your iPhone/iPod will continue charging while in the dock.

Color Change Mode

Color Change Mode can be accessed whether the unit is ON or OFF. There are 3 color settings. Press the **Color Button** to cycle through them. The settings are:

- GLOW Slow color change (default): Colors slowly fade in and out continually from one color to the next.
- FAST Fast color change: colors change quickly from one to another through the color spectrum.
- 1 COLOR Select the last color. **NOTE:** To manually cycle to a desired color, press and release the **<< or >> Button** as needed while the unit is OFF. This function is not available while the unit is ON.
- OFF Turns off cabinet color effect.

Dimmer Mode

When unit is in normal mode (no alarm is sounding), press the **Snooze/Dimmer Button** to cycle through High, Medium, Low, and Off brightness settings. Settings affect both the display and cabinet LED. Dimmer function will not work during GLOW color change mode. When LED color mode is set to OFF, pressing the **Snooze/Dimmer Button** will place unit in 1 COLOR mode with white backlight. Press the **Color Button** again to return color mode to OFF.

Bedtime Sleep Mode

This unit has a Bedtime Sleep feature which gradually lowers the volume of playing audio over a set time then turns the unit off. It will also turn off a docked iPhone or iPod.

1. Press and release the **Sleep Button** as needed to cycle to the desired sleep setting: 120, 90, 60, 30, 15 minutes or Off (cancels sleep mode).
2. To set sleep volume, press the **◀) or ◀)) Buttons**. Sleep volume does not effect normal or alarm volume settings.
3. During sleep mode, press the Sleep Button to view the sleep time remaining. Press again to set sleep to the next lowest setting.
4. To cancel sleep mode and turn the unit off, press and release the **⏻ Button**.

IMPORTANT SAFETY INSTRUCTIONS

When used in the directed manner, this unit has been designed and manufactured to ensure your personal safety. However, improper use can result in potential electrical shock or fire hazards. Please read all safety and operating instructions carefully before installation and use, and keep these instructions handy for future reference. Take special note of all warnings listed in these instructions and on the unit.

1. **Water and Moisture** – The unit should not be used near water. For example: near a bathtub, washbowl, kitchen sink, laundry tub, swimming pool or in a wet basement.
2. **Ventilation** – The unit should be situated so that its location or position does not interfere with its proper ventilation. For example, it should not be situated on a bed, sofa, rug or similar surface that may block ventilation openings. Also, it should not be placed in a built-in installation, such as a bookcase or cabinet, which may impede the flow of air through the ventilation openings.
3. **Heat** – The unit should be situated away from heat sources such as radiators, heat registers, stoves or other appliances (including amplifiers) that produce heat.
4. **Power Sources** – The unit should be connected to a power supply only of the type described in the operating instructions or as marked on the appliance.
5. **Power-Cable Protection** – Power supply cables should be routed so that they are not likely to be walked on or pinched by items placed upon or against them. It is always best to have a clear area from where the cable exits the unit to where it is plugged into an AC socket.
6. **Cleaning** – The unit should be cleaned only as recommended. See the Maintenance section of this manual for cleaning instructions.
7. **Objects and Liquid Entry** – Care should be taken so that objects do not fall and liquids are not spilled into any openings or vents located on the product.
8. **Attachments** – Do not use attachments not recommended by the product manufacturer.
9. **Lightning and Power Surge Protection** – Unplug the unit from the wall socket and disconnect the antenna or cable system during a lightning storm or when it is left unattended and unused for long periods of time. This will prevent damage to the product due to lightning and power-line surges.
10. **Overloading** – Do not overload wall sockets, extension cords, or integral convenience receptacles as this can result in a risk of fire or electric shock.
11. **Damage Requiring Service** – The unit should be serviced by qualified service personnel when:
 - A. the power supply cable or plug has been damaged.
 - B. objects have fallen into or liquid has been spilled into the enclosure.
 - C. the unit has been exposed to rain.
 - D. the unit has been dropped or the enclosure damaged.
 - E. the unit exhibits a marked change in performance or does not operate normally.
12. **Antenna** – Do not connect an external antenna to the unit (other than that provided).
13. **Periods of Nonuse** – If the unit is to be left unused for an extended period of time, such as a month or longer, the power cable should be unplugged from the unit to prevent damage or corrosion.
14. **Servicing** – The user should not attempt to service the unit beyond those methods described in the user's operating instructions. Service methods not covered in the operating instructions should be referred to qualified service personnel.

Questions? Visit www.ihomeaudio.com

Trouble Shooting

Symptom	Possible Problem	Solution
Unit doesn't respond (no power)	AC adaptor isn't plugged to a wall outlet or the connector is not plugged into the power supply jack on the back of the unit	Make sure the AC adaptor is properly connected to a working wall outlet and to the power supply jack on the unit
	Wall outlet is not functioning	Plug another device into the same outlet to confirm the outlet is working
iPhone/iPod cannot dock properly	Possible obstruction in dock area or on iPhone/iPod (skin or case is in the way)	Remove your iPhone/iPod from the connector and check for any obstruction on the connectors in the dock. Try removing case or skin from your iPhone/iPod. Then reseat it in the dock.
Playing iPhone/iPod but there is no sound	iPhone/iPod is not docked properly	Remove your iPhone/iPod from the connector and check for any obstruction on the connectors in the dock and on your iPhone/iPod. Then reseat it in the dock.
	Your iPhone/iPod is not playing	Press play button on your iPhone/Pod to play it manually.
	iPhone/iPod is locked up	Please make sure your iPhone/iPod is working properly before docking it to the unit. Please refer to your manual for details.
	Using 1 st or 2 nd generation iPod, iPod Shuffle or other device	Please connect them with Line-in.
iPhone/iPod didn't charge up	iPhone/iPod is not docked properly	Remove your iPhone/iPod from the connector and check for any obstruction on the connectors in the dock and on your iPhone/iPod. Then reseat it in the dock.
	iPhone/iPod is locked up/frozen	Please make sure your iPhone/iPod is working properly before docking it to the unit. Please refer to your manual for details.
	iPhone/iPod battery has problem	
Sound is distorted	Volume level is set too high	Decrease the unit volume
	Sound source is distorted	If original sound source file is poor quality, distortion and noise are easily noticed with high-power speakers. Try a file from a trusted audio source such as iTunes
		If you are using an iPod Shuffle or external sound source like older generation iPod, try reducing the output volume on the device itself. Also, try turning bass boost OFF under iPod settings.
LED color lighting effect is missing/ not working	LED color mode is set to OFF	Press Color Button to cycle to other color LED modes
	Dimmer is set to OFF	Press Snooze/Dimmer Button to cycle to other brightness modes
	Unit is running on backup battery	Make sure the AC adaptor is properly connected to a working wall outlet and to the power supply jack on the unit

Limited 1 Year Warranty Information

iHome Products, a division of SDI Technologies Inc. (hereafter referred to as SDI Technologies), warrants this product to be free from defects in workmanship and materials, under normal use and conditions, for a period of 1 year from the date of original purchase.

Should this product fail to function in a satisfactory manner, it is best to first return it to the store where it was originally purchased. Should this fail to resolve the matter and service still be required by reason of any defect or malfunction during the warranty period, SDI Technologies will repair or, at its discretion, replace this product without charge (except for a \$20.00 charge for handling, packing, return UPS/postage, and insurance). This decision is subject to verification of the defect or malfunction upon delivery of this product to the Factory Service Center listed below. The product must include proof of purchase, including date of purchase. The fee for service without proof of purchase is \$40.00.

Before returning this product for service, please first replace the batteries (if applicable) with fresh ones, as exhausted or defective batteries are the most common cause of problems encountered.

If service is still required:

1. Remove the batteries (if applicable) and pack the unit in a well padded, heavy corrugated box.
2. Enclose a photocopy of your sales receipt, credit card statement, or other proof of the date of purchase, if within the warranty period.
3. Enclose a check or money order payable to the order of SDI Technologies, for the sum of \$20.00 (\$40.00 without proof of purchase).
4. Send the unit prepaid and insured, to the Factory Service Center listed below.

Consumer Repair Department

SDI Technologies Inc.

1330 Goodyear Drive

El Paso, TX 79936-6420

Disclaimer of Warranty

NOTE: This warranty is valid only if the product is used for the purpose for which it was designed. It does not cover (i) products which have been damaged by negligence or willful actions, misuse or accident, or which have been modified or repaired by unauthorized persons; (ii) cracked or broken cabinets, or units damaged by excessive heat; (iii) damage to digital media players, CD's or tape cassettes (if applicable); (iv) the cost of shipping this product to the Factory Service Center and its return to the owner.

This warranty is valid only in the United States of America and does not extend to owners of the product other than to the original purchaser. In no event will SDI Technologies or any of its affiliates, contractors, resellers, their officers, directors, shareholders, members or agents be liable to you or any third party for any consequential or incidental damages, any lost profits, actual, exemplary or punitive damages. (Some states do not allow limitations on implied warranties or exclusion of consequential damages, so these restrictions may not apply to you.) This warranty gives you specific legal rights, and you may also have other rights which vary from state to state.

Your acknowledgement and agreement to fully and completely abide by the above mentioned disclaimer of warranty is contractually binding to you upon your transfer of currency (money order, cashier's check, or credit card) for purchase of your SDI Technologies product.

© 2011 SDI Technologies, Inc. All rights reserved

**Questions? Visit www.ihomeaudio.com
or call 1-800-288-2792 Toll Free**

Free Manuals Download Website

<http://myh66.com>

<http://usermanuals.us>

<http://www.somanuals.com>

<http://www.4manuals.cc>

<http://www.manual-lib.com>

<http://www.404manual.com>

<http://www.luxmanual.com>

<http://aubethermostatmanual.com>

Golf course search by state

<http://golfingnear.com>

Email search by domain

<http://emailbydomain.com>

Auto manuals search

<http://auto.somanuals.com>

TV manuals search

<http://tv.somanuals.com>