

SMT Power Inductor

SIQ1240R Type

Features

- RoHS compliant.
- High current (10A, 1.4uH), SMD type.
- Magnetically shielded, suitable for high density mounting.
- High energy storage and low DCR.
- Provided with embossed carrier tape packing.
- Ideal for power source circuits, DC-DC converter, DC-AC inverters inductor applications.
- In addition to the standard versions shown here, customized inductors are available to meet your exact requirements.

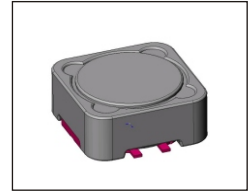

Mechanical Dimension:

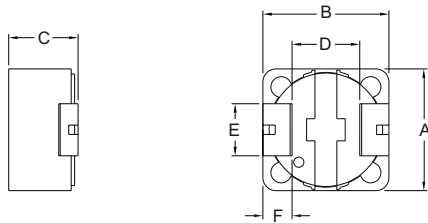

RECOMMENDED PAD PATTERNS

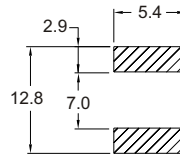

UNIT:mm/inch

A = 12.2 ± 0.3 / 0.480 ± 0.012

B = 12.2 ± 0.3 / 0.480 ± 0.012

C = 4.0 / 0.157 Max.

D = 7.6 ± 0.3 / 0.299 ± 0.012

E = 5.0 / 0.197

F = 2.2 / 0.087

Electrical Characteristics: 25°C: 100KHz, 0.1V

PART NO.	L ¹ (uH)	DCR (mΩ) MAX	I _{rated} ² (A dc)
SIQ1240R - 1R4	1.4	7.8	10.0
SIQ1240R - 4R7	4.7	22.0	5.1
SIQ1240R - 5R6	5.6	27.0	4.7
SIQ1240R - 100	10.0	46.0	3.5

1. Tolerance of inductance : ± 20%.
2. I_{rated} is the DC current which cause the inductance drop less than 25% of its nominal inductance without current and the surface temperature of the part increase less than 45°C.
3. Operating temperature: -20°C to 105°C (including self-temperature rise).



DELTA ELECTRONICS, INC.

(TAOYUAN PLANT CPBG) 252, SAN YING ROAD, KUEISAN INDUSTRIAL ZONE, TAOYUAN SHIEN, 333, TAIWAN, R.O.C.

TEL: 886-3-3591968; FAX: 886-3-3591991

<http://www.deltawww.com>

Free Manuals Download Website

<http://myh66.com>

<http://usermanuals.us>

<http://www.somanuals.com>

<http://www.4manuals.cc>

<http://www.manual-lib.com>

<http://www.404manual.com>

<http://www.luxmanual.com>

<http://aubethermostatmanual.com>

Golf course search by state

<http://golfingnear.com>

Email search by domain

<http://emailbydomain.com>

Auto manuals search

<http://auto.somanuals.com>

TV manuals search

<http://tv.somanuals.com>