

---

**CANDY**

---

**Washing machine**

**Instructions for use**

**CWB 110**

---



## Introduction

Please read these instructions for use carefully and all other information enclosed with the washing machine.

Keep all documentation in a safe place for future reference or for any future owners.

**Note: this machine is solely for domestic use.**

### Notes on disposal

All packaging material used is environmentally-friendly and recyclable. Please help dispose of the packaging via environmentally-friendly means.

**Your supplier or local council will be able to give you details of current means of disposal.**

Valuable materials can be salvaged from an old appliance via scrap reprocessing.

**Note: pull out the mains plug from any old appliance. Cut the power cable and dispose of it, together with the plug.**

When disposing of an old washing machine, please ensure that the door lock is rendered inoperable to prevent children shutting themselves in the appliance.

## Contents

## Page

Introduction	2
General delivery notes	4
Safety notes	4
<b>Quick start</b>	5
Description of controls	6
Programme Table	12
Programme selector	14
Detergent drawer	16
Detergents, washing aids and amounts to use	17
Useful advice for the user	19
The main wash	20
Cleaning and routine maintenance	22
Investigating malfunctions	23
Technical data	25
<b>Setting up + installation</b>	26

**BEFORE SWITCHING ON THE APPLIANCE MAKE SURE IT IS CORRECTLY INSTALLED AND THAT THE TRANSIT BRACKETS ARE REMOVED AS SHOWN IN PAGE 26.**

## General delivery notes

Please check that the following items are delivered with the appliance:

- Instruction manual
- Certificate of guarantee
- Inlet hose
- Liquid detergent or liquid bleach compartment

Check that no damage has occurred during transit, and if so, call your nearest Authorised Technical Support Service agent.

## Safety notes

**Note:**  
for cleaning or maintenance of the washing machine.

- A) Pull out the plug
- B) Turn off the tap
- C) **Candy** equips all its appliances with earthing. Ensure that the mains supply is earthed, and if it is not, seek assistance from a qualified person.
- D) Do not touch the appliance when hands or feet are wet or damp. Do not use the appliance with bare feet.
- E) The use of adapters, multiple connectors and/or extensions is not recommended.

**Note:**  
water temperature can reach 90°C during the wash cycle.

- F) Check there is no water left in the drum before opening the door.
- G) Do not allow children or unauthorised persons to use the appliance without supervision.
- H) Do not pull the power cable or the appliance itself to remove the plug from the socket.
- I) The appliance must not be exposed to weather conditions (rain, direct sun, etc...)
- L) When moving the appliance never lift it by the controls or by the detergent drawer. When in transit never rest the door against the trolley or transport the appliance without the polystyrene base.

### M) **N.B!**

If the appliance is installed on a carpeted floor ensure that the ventilation holes on the base of the appliance are not obstructed.

- N) If the appliance is not running properly or breaks down, switch it off, turn off the tap and do not tamper with the appliance.

Consult only the Authorised Technical Support Service for possible repair and ask them to use original spare parts.

Failure to comply with the above can compromise the safety of the appliance.

- O) If the appliance's power cable should ever need replacing, consult the Authorised Technical Support Service

## Quick start

### Washing

- Open the door by using the button "A" (Fig. 1, page 6)
- Select laundry and put it in the machine
- Close the door
- Put detergent in the compartments as indicated in the programme guide in this instruction manual
- Select programme
- Wait for the "STOP" indicator light to flash

### Press additional function buttons (if required)

- Press the "Start/Pause" button (page 7)
- After few seconds the appliance starts working.

### After washing

- The indicator light "STOP" will go on.
- Wait for the door lock to be released (about 2 minutes after the programme has finished). The "Door Security" indicator light will go out.
- Switch off the washing machine by turning the selector to "OFF" position.
- Open the door and remove the laundry.

Ensure that the machine is correctly installed in line with the instructions found on page 26.

## Description of controls

Fig. 1

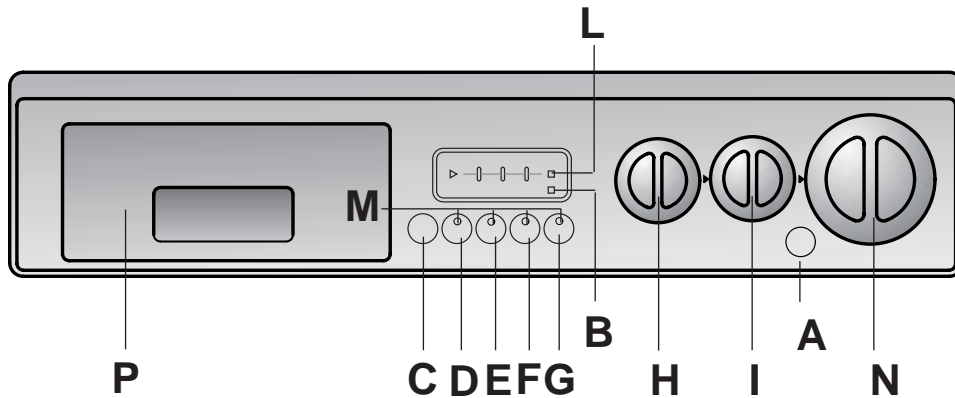

Door open button	A
Door locked indicator light	B
Start button	C
Start Delay button	D
Super rapid button	E
Extra Rinse button	F
Crease guard button	G
Spin speed control	H
Wash Temperature Control Knob	I
"Time to end" indicator light	L
Buttons indicator light	M
Timer knob for wash programmes with OFF position	N
Detergent drawer	P

## Door open button **A**

Important:

a special safety device prevents the door from opening at the end of the wash/spin cycle. at the end of the spin phase wait up to 2 minutes before opening the door.

## DOOR SECURITY indicator light **B**

The "Door Security" indicator light is illuminated when the door is fully closed and the machine is ON. When "Start/Pause" is pressed on the machine with the door closed the indicator will flash momentarily and then illuminate.

**If the door is not closed the indicator will continue to flash.**

A special safety device prevents the door from being opened immediately after the end of the cycle. Wait for 2 minutes after the wash cycle has finished and the "Door Security" light has gone out before opening the door. At the end of the cycle turn the programme selector to "OFF".

## START/PAUSE button **C**

**When a programme is selecting, wait for the "STOP" indicator light to flash before pressing the "Start/Pause" button.**

Press to start the selected cycle (according to the selected cycle one indicator lights will go on).

**NOTE: When the "Start/Pause" button has been pressed, the appliance can take few seconds before it starts working.**

### Changing the settings after the programmes has started (PAUSE)

The programme may be paused at any time during the wash cycle by holding down the "Start/Pause" button for about two seconds. When the machine is in the paused mode, the indicator light "Time to end" and option buttons will flash.

To restart the programme, press the "Start/Pause" button once again.

If you wish to add or remove items during washing, wait 2 minutes until the safety device unlocks the door.

When you have carried out the manoeuvre, close the door, press "Start/Pause" button and the appliance will continue working where it left off.

### CANCELLING THE PROGRAMME

To cancel the programme the programme selector should be rotated to the "OFF" position.

The option buttons should be selected before pressing the "Start/Pause" button.

## START DELAY BUTTON **D**

Appliance start time can be set with this button, delaying the start by 3, 6 or 9 hours.

Proceed as follows to set a delayed start:

Select a programme ("STOP" indicator light blinks)

Press Start Delay button (each time the button is pressed the start will be delayed by 3, 6 or 9 hours respectively and the corresponding light will blink).

Press START to commence the Start Delay operation (the indicator light associated with the selected Start Delay time stops blinking and remains ON).

At the end of the required time delay the programme will start.

To cancel the Start Delay function :

press the Start Delay button until the indicator lights will be off (The STOP light blinks) and the programme can be started manually using the START button or switch off the appliance by turning the programme selector to off position.

---

## SUPER RAPID button **E**

Pressing this button reduces the time of the wash programme by a maximum of 50 minutes depending on the programme and the temperature selected. The "Super Rapid" button can be used for washing loads of 1 to 5,5 kg. This option may only be utilised on **COTTONS** and **SYNTHETICS** programmes.

---

## EXTRA RINSE BUTTON **F**

Thanks to the new electronic system, acting on the button is possible to effect a new special rinse cycle. The addition of a lot of more water and the new action combined of cycles of rotation of the drum with load and unloading of water, allow to get laundry perfectly rinsed.

This function has been studied for the people with delicate and sensitive skin, for which also a least residue of detergent can cause irritations or allergies.

It advises to also use this function for the children items and in case of washings of very dirty items, for which it is due to use a lot of detergent, or in the washing of towelling items whose fibers mostly have the tendency to hold the detergent.

This button is not available in the Wool/Hand wash programmes.

## CREASE GUARD button **G**

Press the button to select or deselect this function.

The Crease Guard function minimizes creases as much as possible with a uniquely designed anti-crease system that is tailored to specific fabrics.

**MIXED FABRICS** - the water is gradually cooled throughout the final two rinses with no spinning and then a delicate spin assures the maximum relaxation of the fabrics.

**DELICATE FABRICS** – final two rinses with no spinning and then the fabrics are left in water until it is time to unload. When you are ready to unload, press the "**Crease Guard**" button – this will drain.

**WOOLLENS/HAND WASH** – after the final rinse the fabrics are left in water until it is time to unload **and the button indicator blinking.**

When you are ready to unload, press the "**Crease Guard**" button, this will drain and spin ready for emptying.

If you do not want to spin the clothes and activate drain only:

- Turn the programme selector to the "**OFF**" position;
- Select programme drain only ;
- Switch on the appliance again by pressing the "**Start/Pause**" button.

## VARIABLE SPIN SPEED selector

H

Can be turned in either direction

The spin stage plays a very important role in preparing the laundry for efficient drying and your model offers maximum flexibility to suit all your requirements.

The selector can be turned to reduce the maximum spin speed, right up to eliminating the spin completely (position ).

In programmes for mixed fibres, synthetics and delicates, the washing machine automatically lowers the spin speed.

In order not to damage fabrics, it is not possible to increase this spin speeds.

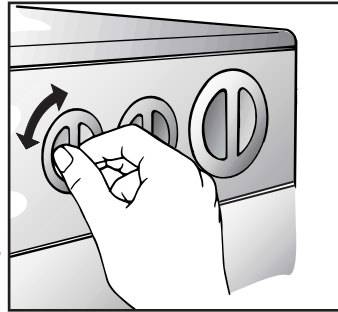

**Note:** this model is fitted with an electronic device that checks the load is balanced correctly. If the load is slightly unbalanced the machine will re-balance it automatically to carry out the normal spin.

If, after several attempts, balance is not restored, a reduced spin speed will be used.

If loads are seriously unbalanced the spin stage will be cancelled. This helps limit vibration, reduce noise output and improve the washing machine's lifespan.

## WASH TEMPERATURE CONTROL KNOB

I

ROTATES IN BOTH DIRECTIONS

With this device it is possible to reduce, but no increase washing cycle temperature.

The table of programmes indicate the maximum temperature advised for each type of wash.

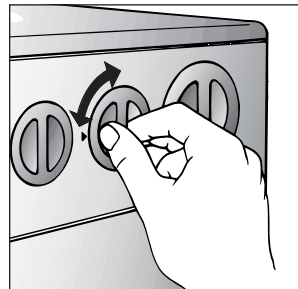

**WARNING: THIS TEMPERATURE MUST NEVER BE EXCEEDED**

## TIME TO END indicator light

L

In order to manage your time better, this washing machine features an indicator light system that keeps you constantly informed on the remaining cycle time.

### Indicator light START:

Remaining time above 60 minutes.

### Indicator light 60:

Remaining time less than 60 minutes.

### Indicator light 30:

Remaining time less than 30 minutes.

### Indicator light 15:

Remaining time less than 15 minutes.

### Indicator light STOP:

End of the programme.

## Buttons indicator light

M

The indicator light around the option buttons will light when specific options are selected.

## PROGRAMME selector with "OFF" position

N

Rotates in both directions.

The machine is turned on by selecting a programme via the programme selector. This status will be indicated by the "STOP" indicator light flashing, this light will continue to flash until the machine has started or the machine is returned to the "OFF" position.

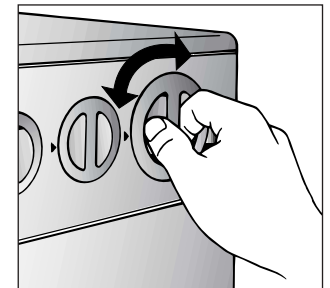

Press the **"Start/Pause"** button to start the selected cycle.

Once a programme is selected the programme selector remains stationary on the selected programme till cycle ends.

Switch off the washing machine by turning the selector to **"OFF"**.

**Note:**

The programme selector must be returned to the "OFF" position at the end of each cycle or when starting a subsequent wash cycle prior to the next programme being selected and started.

TABLE OF PROGRAMMES

PROGRAM FOR:	PROGRAMME SELECTOR ON:	WEIGHT MAX kg	TEMP. °C	CHARGE DETERGENT		
				II	☼	I
<b>Resistant fabrics</b> Cotton, linen	Whites with prewash 90°C P	5,5	Up to 90°	●	●	●
Cotton, mixed	Fast coloureds 60°C **	5,5	Up to 60°	●	●	
	Fast coloureds 40°C	5,5	Up to 40°	●	●	
	Non fast coloureds 30°C	5,5	Up to 30°	●	●	
<b>Mixed fabrics and synthetics</b> Mixed, resistant	Fast coloureds with Prewash 60°C P	2,5	Up to 60°	●	●	●
Synthetics (nylon, perlon), mixed cotton	Fast coloureds 50°C **	2,5	Up to 50°	●	●	
	Non fast coloureds 40°C	2,5	Up to 40°	●	●	
<b>Very delicate fabrics</b>	Delicates 40°C **	1,5	Up to 40°	●	●	
	"MACHINE WASHABLE" woollens 40°C ☼	1	Up to 40°	●	●	
	Hand wash 30°C ☞	1	Up to 30°	●	●	
<b>Specials</b>	Rinse ☞	-	-	△	●	
	Fast spin ☉	-	-			
	Drain only ☞	-	-			
	"Mix & wash" System programme M&W 40°C	5,5	Up to 40°	●	●	
	Rapid 32 minute 32' 50°C	2	Up to 50°	●		

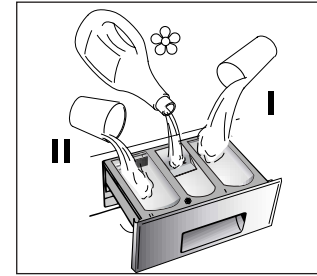

Please read these notes

When washing heavily soiled laundry it is recommended the load is reduced to 3 kg maximum.

\*\* Programme also recommended for low temperature wash (below the indicated Max. temperature). Programmes according to CENELEC EN 60456.

The spin speed may also be reduced, to match any guidelines suggested on the fabric label, or for very delicate fabrics cancel the spin completely this option is available with a spin speed button.

■ The variable temperature selector allows a reduction in the wash temperature. For example, an intense cottons cycle can be washed in cold water simply by moving the dial to the ☼ symbol.

△ When only a limited number of articles have stains which require treatment with liquid bleaching agents, preliminary removal of stain can be carried out in the washing machine. Pour the bleach into the liquid bleach container, inserted into the compartment marked "II" in the detergent drawer, and set the special programme "RINSE" ☞. When this phase has terminated, turn the programme selector on the "OFF" position, add the rest of the fabrics and proceed with a normal wash on the most suitable programme.

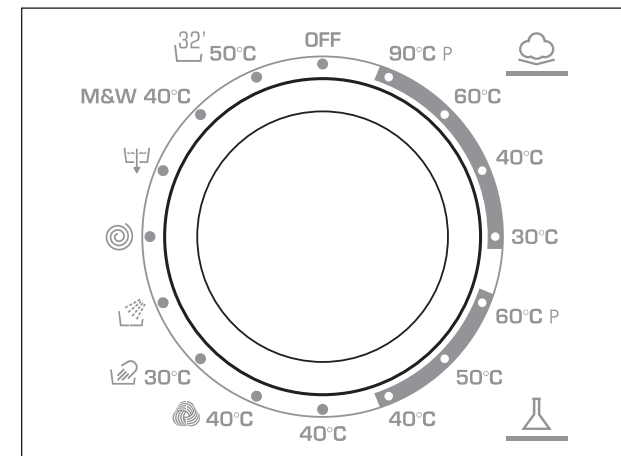



# Programme selector

For the various types of fabrics and various degrees of dirt the washing machine has different programme bands according to: wash cycle, temperature and length of cycle (see table of washing cycle programmes).

## 1 RESISTANTS FABRICS

The programmes have been designed for a maximum wash and the rinses, with spin intervals, ensure perfect rinsing. The final spin gives more efficient removal of water.



## 2 MIXED AND SYNTHETIC FABRICS

The main wash and rinse gives the best results thanks to the rotation rhythms of the drum and to the water levels. A gentle spin will mean that the fabrics become less creased.



## 3 SPECIAL DELICATE FIBRES

This is a new wash cycle which alternates washing and soaking and is particularly recommended for very delicate fabrics such as Pure Machine Washable Wool. The wash cycle and rinses are carried out with high water levels to ensure best results.



## “HAND WASH”

This washing machine also has a gentle Hand Wash programme cycle. This programme allows a complete washing cycle for garments specified as “Hand Wash only” on the fabric care label. The programme has a temperature of 30°C and concludes with 3 rinses and a slow spin.



## 4. SPECIALS

### SPECIAL “MIXED RINSES” PROGRAMME

This programme carries out three rinses with a intermediate spin. It can be used for rinsing any type of fabric, eg. use after hand-washing.

This program can be also used as cycle of Bleaching (see table of washing cycle programmes).



### SPECIAL “FAST SPIN” PROGRAMME

Programme “FAST SPIN” carries out a maximum spin.



### DRAIN ONLY

This programme drains out the water.



## “MIX & WASH SYSTEM” PROGRAMME

This is an exclusive **Candy** system and involves 2 great advantages for the consumer:

- to be able to wash together different type of fabrics (e.g. cotton + synthetic etc...) **NON-FAST COLOURED**S;
- to wash with a considerable energy saving.

The "Mix & Wash" programme has a temperature of 40°C and alternate dynamic phases (the drum that turns) to static phases (fabrics in soak in phase of rest) with the programme duration that almost reaching the 3 hours. The energy consumption for the complete cycle is only 850 W/h.

### Important:

- the first washing of new coloureds fabrics must be done separately;
- in every case, **never mix NON-FAST COLOURED**S fabrics.

## 32 MINUTE RAPID PROGRAMME 50°C

The 32 minute rapid programme allows a complete washing cycle to be carried out in approximately 30 minutes, with up to a maximum load of 2 kg and a temperature of 50°C.

When selecting the "32 minute rapid" programme, please note that we recommend you use only 20% of the recommended quantities shown on the detergent pack.



## Automatic Variable Capacity

The washing machine is fitted with an automatic reduction in consumption system (known as Automatic Variable Capacity).

This system enables the machine to use the amount of water needed to wash and rinse the laundry in relation to the particular load.

This results in a reduction in the amount of water used and electricity needed to heat it to the minimum required, without in any way compromising the washing and rinsing performance.

In fact the amount of water and electricity used will always be appropriate for the amount of washing.

The washing machine therefore ensures you achieve excellent washing results whilst respecting the environment and saving you money.



## Detergent drawer

The detergent drawer is split into 3 compartments:

- the compartment labelled "I" is for prewash detergent;
- the compartment labelled "☼" is for special additives, fabric softeners, fragrances, starch, brighteners etc;
- the compartment labelled "II" is for main wash detergent.

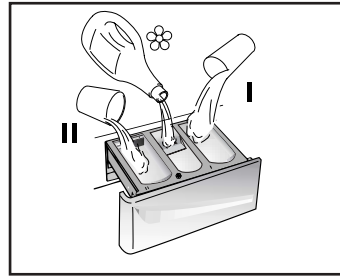

If liquid detergents are used, please insert the special container supplied into the compartment marked "II" in the detergent drawer. This ensures that the liquid detergent enters the drum at the right stage of the wash cycle.

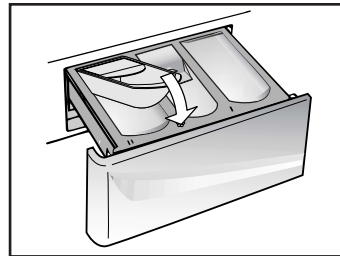

This special container must be inserted into the compartment marked "II" in the detergent drawer, also when you wish to use the "RINSE" programme as BLEACHING cycle.

### NOTE:

Some Detergents are Difficult to utilise. Ensure to use an in drum dispenser if recommended by the detergent Manufacturer.

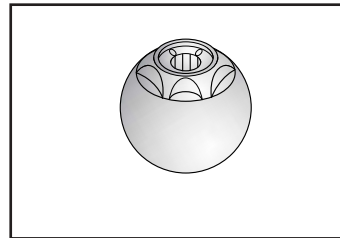

Note: only put liquid products in the compartment labelled "☼". The machine is programmed to automatically take up additives during the final rinse stage for all wash cycles.

## Detergents, washing aids and amounts to use

### Choice of detergent

#### General purpose detergents

- **Powder detergents**, for a thorough wash, with bleaching agent, particularly suitable for use in hot wash programmes (60°C and over), for heavily soiled and stained laundry.
- **Liquid detergents**, particularly suitable for grease stains, such as greasy skin marks, cosmetics and oil.  
These detergents are not suitable for washing stained laundry, as they do not contain bleach.
- **Biological detergents**, not all the products available give a really thorough wash.

#### Additional laundry aids

- **Water softener**, means less detergent can be used where water hardness is classed as hard to very hard.
- **Prewash substances**, for the programmed treatment of stains prior to the main wash. Using them means the subsequent wash can be at a low temperature or with bleach-free detergents.
- **Fabric softener**, prevents static build-up in synthetic fabrics and softens fabrics. If you own a tumble dryer, clothes are softened even without the use of a fabric softener.

#### Do not put solvents in the washing machine!

Keep detergents and other laundry products out of children's reach.

Before pouring in the detergent check that there are no foreign bodies in the detergent drawer.

Dosage details are usually shown on the detergent packaging. Follow those instructions.

## Dosages

Only use detergents which are suitable for use in a washing machine.

You will obtain the best results from your wash with the minimum use of chemical products and the best care for your laundry if you take into consideration the degree of soiling as well as the type of detergent to choose.

The amount of detergent to use depends on:

- water hardness: depending on the hardness of the water and the type of detergent used, it is possible to reduce the amount of detergent.
- the degree of soiling: it is possible to reduce the amount of detergent used depending on the degree of soiling.
- amount of laundry: it is possible to reduce the amount of detergent when washing only a small amount of laundry.

### Dosage for powder detergent

**For normal and low concentration detergents:** for normally soiled laundry choose a programme without prewash.

Put the detergent in compartment "II" of the drawer.

For heavily soiled laundry, choose a programme with prewash.

Put 1/4 of the detergent in compartment "I", 3/4 in compartment "II" of the drawer.

When using water softeners, first put in the detergent, then add the softener to compartment "II".

For highly concentrated detergents not in single dose format, follow what is shown on pack exactly as regards type and amount of dosage.

To avoid the difficulty of checking if the detergent has been taken up, use the dosage aids provided in the detergent packaging.

### Liquid detergent dosage

Liquid detergents may be used in accordance with the instructions on the relevant packaging, for all programmes without prewash, by using the special container which is placed in the drum or, for those models that have it, in the special insert for liquid detergents.

## Useful advice for users

Tips on using your domestic appliance in the most environmentally-friendly and economical way

### Do a full load in your washing machine

To prevent any possible waste of energy, water or detergent we recommend that you put a full load in your washing machine, not exceed the recommended maximum load size. Up to 50% energy saving can be made with one full load compared to two half load washes

### When is prewashing really needed?

Only with particularly dirty loads!

Energy savings of 5 to 15% are made by not selecting the prewash option for normal soiled laundry.

### Which wash temperature should you choose?

Using stain removers before machine washing reduces the need to wash at temperatures over 60°C.

Energy savings of up to 50% can be made by using a 60°C wash temperature rather than 90°C.

# Main wash

## Sorting the laundry

- It is recommended you wash only items which are machine washable with water and detergent and not dry-clean items.
- If you need to wash rugs, bedspreads or other heavy items, it is best not to spin them.
- Sort the laundry according to fabric type, degree of soiling and wash temperature: Always follow the wash care advice on the garment label for the most suitable care and treatment of the laundry

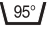
**Laundry for hot wash** 

**Coloured, easy-care materials**   

**Delicates and wool**  

**Wash by hand** 

Items labelled with the following symbol are not suitable for machine washing:

**Dry clean** 

For very delicate items, such as net curtains, underwear, tights etc., you are advised to use a laundry net or wash bag.

- Woollen items must be labelled with the "Pure New Wool" symbol to be washed in the machine , and must also be labelled "non-matting" or "machine washable".
- Colour often leaks from new coloured items.

This can then colour other lighter items being washed.

We therefore recommend that coloured items should be washed for the first time separately.

For future washes, colourfast items can only be washed with whites up to 40°C.

## Note: when sorting laundry

- check there are no metal objects in the laundry (such as paper clips, safety pins, pins, coins etc...);
- button up pillowcases, fasten zips, hook & eye fasteners, belts and long dressing gown cords;
- remove curtain hooks;
- pay close attention to the labels on items
- if you notice stubborn stains whilst sorting the laundry, remove them using a special detergent or a special stain remover.

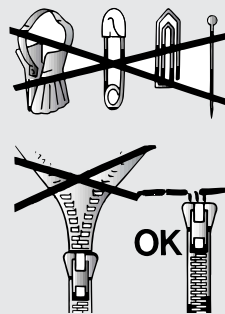

- We recommend that you do not do a full load of towelling items only as these become too heavy since they absorb a lot of water.

## The correct way to wash

### Preparing the laundry

A) Select the laundry.

### Loading the laundry

B) Open the porthole.

C) Put the laundry in the washing machine.

Close the porthole again, ensuring that no items of laundry are obstructing the lock.

### Putting detergent in machine

D) Open the drawer, choose the detergent and put in the correct amount, according to the manufacturer's instructions and the advice on page 17.

Add any other laundry aids (see page 17). Close the drawer again.

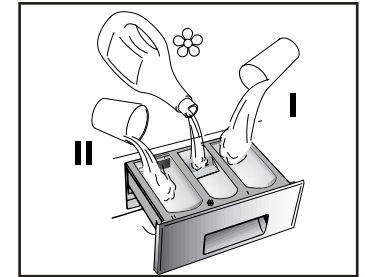
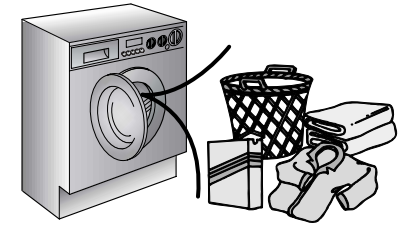

## Selecting the wash programme

Refer to the programme guide or the programme descriptions on the machine to select the most suitable programme.

Turning the selector knob, the required programme is activated.

Wait for the "STOP" indicator light to flash.

### Press additional function buttons (if required).

Check that the tap is turned on and that the discharge hose is positioned correctly.

Press the "Start/Pause" button.

When the "Start/Pause" button is pressed the machine sets the working sequence in motion.

The programme carries out with the programme selector stationary on the selected programme till cycle ends.

**Warning:** If there is any break in the power supply while the machine is operating, a special memory stores the selected programme and, when the power is restored, it continues where it left off.

## When the programme is finished

At the end of the programme the indicator light "STOP" will go on.

Wait for the door lock to be released (about 2 minutes after the programme has finished).

The "Door Security" indicator light will go out.

Switch off the machine by turning the programme selector on the "OFF" position. Open the door and remove the laundry. Turn off the tap.

## Cleaning and routine maintenance

Do not use alcohol-based scourers and / or thinners on the outside of your washing machine, just a wipe with a damp cloth will suffice. The washing machine needs very little maintenance:

- Cleaning the drawer compartments.
- Cleaning the door glass.

### Cleaning the drawer compartments

Even if it is not strictly necessary, it is good to clean the compartments for bleaching detergents and additives occasionally.

- A) To do this you just need to pull them out firmly, but without forcing them.
- B) Clean everything in the compartment under running water.
- C) Put everything back in its proper place.

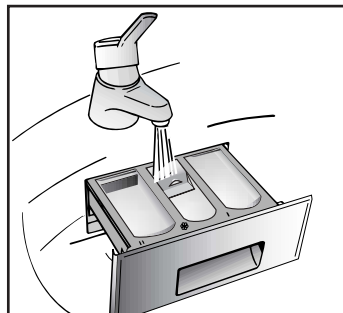

### Cleaning the door glass

Regularly clean the door glass with a damp cloth. A build up of soiling and residues from the water may result in water leaking from the door.

Do not use abrasive cleaners as they can scratch the surface.

### Transporting the appliance or long periods when appliance is not in use

If the appliance is being transported or is out of use for long periods in unheated places, all remaining water must be completely removed from the hoses.

Ensure mains power is off, then unclip the hose and point it downwards into a basin until all the water has emptied out.

When finished, repeat the operation in the reverse order.

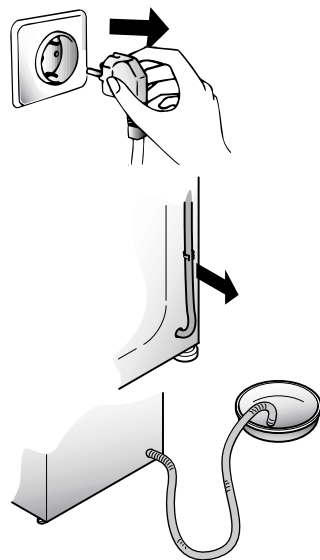

## Investigating malfunctions

What might be the cause of...  
Defects you can remedy yourself

MALFUNCTION	CAUSE	REMEDY
1. Does not work on any programme	Plug not in socket. Not switched on. Power failure. Fuse blown. Door open.	Plug it in. Switch on. Check. Check. Close door.
2. Does not fill with water	See cause 1. Tap turned off. Programme selector not correctly positioned. Fill hoses are kinked	Check. Turn on tap. Position programme selector correctly. Straighten fill hoses
3. Water does not drain away	Kink in discharge hose. House drain is blocked	Straighten discharge hose. Clean drain
4. Water on floor around the washing machine	Leaking gasket between tap and water inlet hose. House drain is blocked Soap drawer blocked with soap residues	Replace gasket and tighten hose and tap well. Clean drain Clean soap drawer
5. Does not spin	Water has not yet drained away. "No spin" selected (certain models only).	Wait a few minutes for machine to empty. Reset button or turn "no spin" knob.
6. Machine vibrates a lot during spin	Washing machine not completely level. Transit brackets not removed yet. Load not distributed evenly.	Adjust the special adjustable feet. Remove transit brackets. Rearrange the laundry evenly.
7. Door will not open	Two minutes have not elapsed since the programme finished.	Wait two minutes.

The machine makes a different noise when spinning! This is because it has a brush motor for better performance.

Only a small level of water can be seen in the drum! This is because new machines do not use much water, yet achieve the same standard of washing and rinsing.

**Note:**

The use of environmentally-friendly, phosphate-free detergents can have the following effects:

- waste water from rinsing may be cloudier because of the presence of zeolites held in suspension, without the rinse performance being adversely affected;
- presence of white powder (zeolites) on laundry after washing, which is not absorbed by the fabric and does not alter the colour of the fabric.
- The presence of foam in the final rinsing water is not necessarily an indication of poor rinsing.
- Anionic surfactants used in washing detergent formulae often prove to be difficult to remove from the laundry itself and, even in small quantities, can still cause considerable foam production.
- Carrying out more rinse cycles does not serve any purpose in such cases.

## CUSTOMER SERVICE AND GUARANTEE

Your new appliance is fully guaranteed by the manufacturer for 12 months against electrical/mechanical breakdown excluding:

- A.** Any faults which occur due to bad installation or misuse of the machine.
- B.** Any faults which occur due to repair of, or interference with, the machine by any person not authorised by the manufacturer to carry out service.
- C.** Any faults which arise from parts fitted to the machine which are not the manufacturers original parts.
- D.** Any faults arising from non-domestic use or unusual or abnormal use of the machine.
- E.** Any faults arising from operation at an incorrect voltage.
- F.** Any faults arising from incorrect operation of the machine.

The guarantee applies to Gt. Britain and Northern Ireland only, and is an addition to your statutory rights.

### After Sales Service

If, having investigated the possible malfunctions on the chart on the previous page, you believe the appliance is not working correctly, please call our After Sales Service dept. on telephone number:

<b>Gias Service</b>	-	<b>Tel: 08705 400 600</b>
<b>Support Service</b>		<b>(Eire 018301 666)</b>

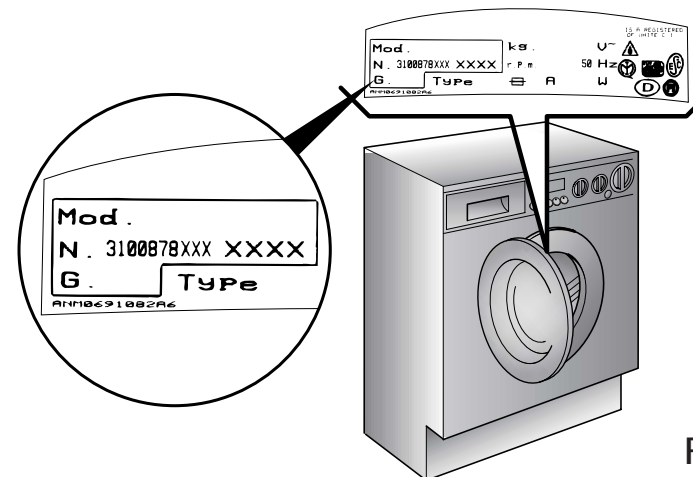

Fig. 2

### Technical data

- Max. load of dry laundry for washing
- Water pressure

5,5 kg  
0,05 ÷ 0,8 MPa

#### Measurements

- Width
- Depth
- Height

60 cm  
54 cm  
82 cm

NB: For specifications regarding electrical data, see the data panel on the front of the washing machine (porthole area) - as shown in diagram above.

**CE** EC Appliance complies with European Directive 89/336/EEC, 73/23/EEC and subsequent amendments.



# SETTING UP + INSTALLATION

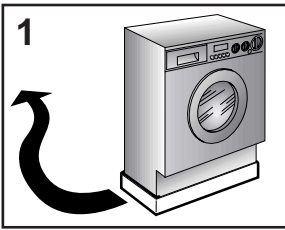

1 Remove the polystyrene base and place the machine near its permanent position (diagram 1).

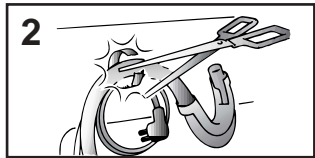

Carefully cut through the hose retaining clip at the rear of the appliance (diagram 2).

Unscrew the central bolt (A); unscrew the 4 lateral screws (B) and remove the cross piece (C). Unscrew the two rods D and remove them. Two plastic spacers will fall inside the machine. (diagram 3).

Lean the machine forward, remove the mentioned plastic spacers and remove the plastic bags containing the two polystyrene blocks at the sides, pulling downwards. (diagram 4).

Stop the holes using the plugs that you will find inside the bag containing the instruction booklet. (diagram 5).

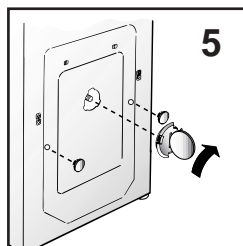
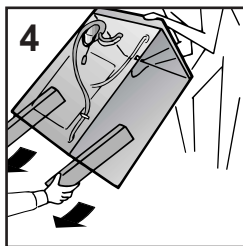
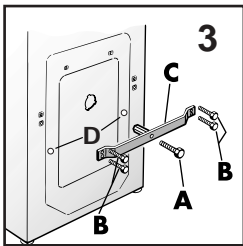

**WARNING:**  
DO NOT LEAVE THE PACKAGING WITHIN REACH OF CHILDREN AS IT IS A POTENTIAL SOURCE OF DANGER.

Apply the insulation sheet of corrugated material to the base as shown.

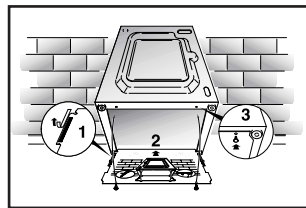

Level the machine using the 4 feet.

- Turn the nut clockwise to release the screw adjuster on the foot.
- Rotate the foot to raise or lower it until it stands firmly on the ground.
- Lock the foot in position by turning the nut anti-clockwise until it comes up against the bottom of the machine.

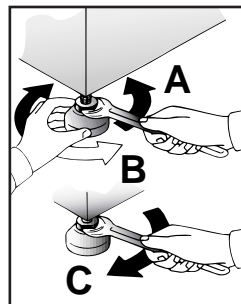

Note: we recommend you keep the transit bracket, braces and screws to immobilise the machine for future transit.

The Manufacturers will not be responsible for any possible damage to the machine caused by not following the rules relating to releasing the mechanism. The user is responsible for all costs of installation.

## Water connection

The appliance must be connected to the water mains using new hose-sets.

The old hose-sets should not be re-used.

The machine has an inlet hose with 3/4" B.S.P threaded end connection to attach between the threaded connector on the appliance and the cold water supply.

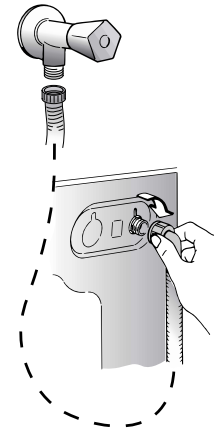

This machine only uses cold water, therefore only one hose is needed to connect to the cold water supply. Do not connect to the hot supply. Cold fill is an energy efficient system. Only the water required for the washing is heated. There is no loss of heat in the pipeline from a hot water tank or boiler to the machine.

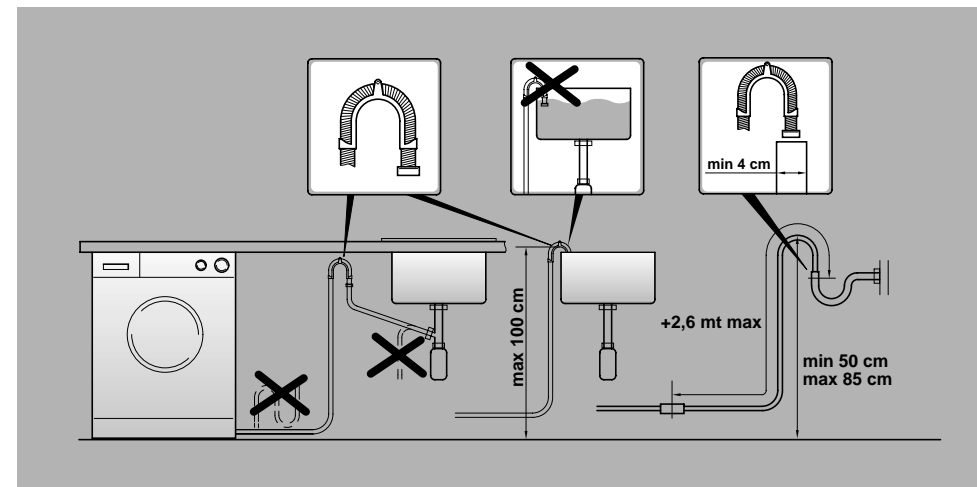

**Note:** it is advisable to turn off the tap after each wash to isolate the washing machine from the water supply.

For the washing machine to function properly the terminal end of the discharge hose (mouth) must be at a minimum of 50 cm and a maximum of 85 cm from the ground.

## ELECTRICAL CONNECTIONS

After installation, the appliance must be positioned so that the plug is accessible.

If the plug we supply does not fit

**CUT IT OFF AND DESTROY IT!**

You can't use it on other appliances, and the exposed wires could be dangerous if plugged in.

To fit a replacement plug, proceed as follows:

<b>Connect</b>	<b>to the terminal in the plug</b>
green and yellow wire	marked with the letter E, OR marked with the symbol,  OR coloured green, OR coloured green and yellow.
blue wire	marked N OR coloured black.
brown wire	marked L OR coloured red.

## WARNING

This appliance must be earthed

Fuses and plugs

This appliance should be used only on a socket with a minimum rating of 13 Amp.

Our ready-fitted plug is already equipped with a 13 amp fuse which is BS 1362 ASTA approved. Any replacement should be exactly the same.

If the fuse cover is lost, do not use the plug until it is replaced. A correct replacement fuse cover (obtainable from your local retailer) must be the same colour as shown or named on the insert on the base of the plug.



The manufacturer declines all responsibility in the event of any printing mistakes in this booklet. The manufacturer also reserves the right to make appropriate modifications to its products without changing the essential characteristics.

---

# CANDY

---

This appliance is marked according to the European directive 2002/96/EC on Waste Electrical and Electronic Equipment (WEEE).

By ensuring this product is disposed of correctly, you will help prevent potential negative consequences for the environment and human health, which could otherwise be caused by inappropriate waste handling of this product.

The symbol on the product indicates that this product may not be treated as household waste. Instead it shall be handed over to the applicable collection point for the recycling of electrical and electronic equipment. Disposal must be carried out in accordance with local environmental regulations for waste disposal.

For more detailed information about treatment, recovery and recycling of this product, please contact your local city office, your household waste disposal service or the shop where you purchased the product.



EN

06.05 - 41020682 - www.graficaestampa.it - Printed in Italy - Imprimé en Italie



## Free Manuals Download Website

<http://myh66.com>

<http://usermanuals.us>

<http://www.somanuals.com>

<http://www.4manuals.cc>

<http://www.manual-lib.com>

<http://www.404manual.com>

<http://www.luxmanual.com>

<http://aubethermostatmanual.com>

Golf course search by state

<http://golfingnear.com>

Email search by domain

<http://emailbydomain.com>

Auto manuals search

<http://auto.somanuals.com>

TV manuals search

<http://tv.somanuals.com>