

beko

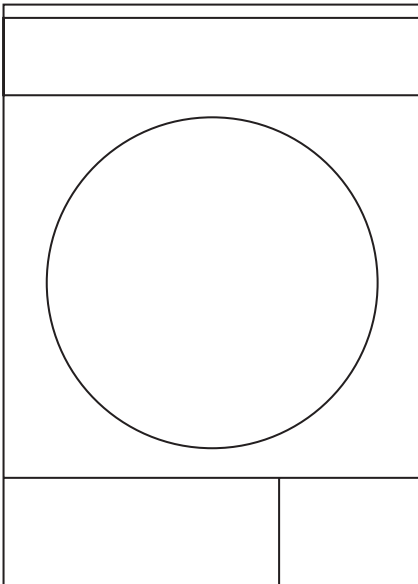

Dryer
User Manual

DCY 7202 XW3



2960311039_EN/220115.1711

Please read this user manual first!

Dear Customer,

Thank you for preferring a Beko product. We hope that your product which has been manufactured with high quality and technology will give you the best results. We advise you to read through this manual and the other accompanying documentation carefully before using your product and keep it for future reference. If you transfer the product to someone else, give its manual as well. Pay attention to all details and warnings specified in the user manual and follow the instructions given therein.

Use this user manual for the model indicated on the cover page.

Explanation of symbols

Throughout this user manual the following symbols are used:

	Important information or useful hints about usage.
	Warning for hazardous situations with regard to life and property.
	Warning against electric shock.
	Warning against hot surfaces.
	Warning against fire hazard.
	Packaging materials of the product are manufactured from recyclable materials in accordance with our National Environment Regulations.

Do not dispose of the packaging wastes with the domestic waste or other wastes, discard them to the dedicated collection points designated by the local authorities.

1 Important instructions for safety and environment

This section contains safety instructions that will help protect from risk of personal injury or property damage. Failure to follow these instructions shall void any warranty.

1.1 General safety

- The dryer can be used by children at and above 8 years old and by persons whose physical, sensory or mental capabilities were not fully developed or who lack experience and knowledge provided that they are supervised or trained on the safe usage of the product and the risks it brings out. Children should not play with the product. Cleaning and maintenance works should not be performed by children unless they are supervised by someone.
- Children of less than 3 years should be kept away unless continuously supervised.
- Adjustable feet should not be removed. The gap between the dryer and the floor should not be reduced with materials such as carpet, wood and tape. This will cause problems with the dryer.
- Always have the installation and repairing procedures carried out by the **Authorized Service**. Manufacturer shall not be held liable for damages that may arise from procedures carried out by unauthorized persons.
- Never wash the dryer by spraying or pouring water onto it! There is the risk of electric shock!

Important instructions for safety and environment

1.1.1 Electrical safety



Electrical safety instructions should be followed while electrical connection is made during the installation.

- Connect the dryer to a grounded outlet protected by a fuse at the value specified on the type label. Have the grounding installation performed by a qualified electrician. Our company shall not be liable for any damages that will arise when the dryer is used without grounding in accordance with the local regulations.
- The voltage and allowed fuse protection is stated on the type label plate.
- The voltage specified on the type label must be equal to your mains voltage.
- Unplug the dryer when it is not in use.
- Unplug the dryer from the mains during installation, maintenance, cleaning and repair works.
- Do not touch the plug with wet hands! Never unplug by pulling on the cable, always pull out by grabbing the plug.
- Do not use extension cords, multi-plugs or adaptors to connect the dryer to power supply in order to decrease the risk of fire and electric shock.
- Power cable plug must be easily accessible after installation.



Damaged mains cable should be changed notifying the Authorized Service.



If the dryer is faulty, it must not be operated unless it is repaired by an authorized service agent! There is the risk of electric shock!

Important instructions for safety and environment

1.1.2 Product safety



Points to be taken into consideration for fire hazard:

Below specified laundry or items must not be dried in the dryer considering fire hazard.

- Unwashed laundry items
- Items soiled with oil, acetone, alcohol, fuel oil, kerosene, stain removers, turpentine, paraffin or paraffin removers must be washed in hot water with plenty of detergent before being dried in the dryer.

For this reason especially the items containing the above specified stains must be washed very well, to do this use adequate detergent and choose a high washing temperature.



Below specified laundry or items must not be dried in the dryer due to the fire hazard:

- Garments or pillows bolstered with rubber foam (latex foam), shower bonnets, water resistant textiles, materials with rubber reinforcement and rubber foam pads.
- Clothing cleaned with industrial chemicals.

Items such as lighter, match, coins, metal parts, needle etc. may damage the drum set or may lead to functional problems. Therefore check all the laundry that you will load into your dryer.

Never stop your dryer before the programme completes. If you must do this, remove all laundry quickly and lay them out to dissipate the heat.



Clothes that are washed inadequately may ignite on their own and even may ignite after drying ends.

Important instructions for safety and environment

- You must provide enough ventilation in order to prevent gases exiting from devices operating with other types of fuels including the naked flame from accumulating in the room due to the back fire effect.



Underwear that contains metal reinforcements should not be dried in the dryer. Dryer may be damaged if metal reinforcements come loose and break off during drying.



Use softeners and similar products in accordance with the instructions of their manufacturers.



Always clean the lint filter before or after each loading. Never operate the dryer without the lint filter installed.

- Never attempt to repair the dryer by yourself. Do not perform any repair or replacement procedures on the product even if you know or have the ability to perform the required procedure unless it is clearly suggested in the operating instructions or the published service manual. Otherwise, you will be putting your life and others' lives in danger.
- There must not be a lockable, sliding or hinged door that may block the opening of the loading door in the place where your dryer is to be installed.
- Install your dryer at places suitable for home use. (Bathroom, closed balcony, garage etc.)
- Make sure that pets do not enter the dryer. Check the inside of the dryer before operating it.
- Do not lean on the loading door of your dryer when it is open, otherwise it may fall over.
- The lint must not be allowed to accumulate around the tumble dryer

Important instructions for safety and environment

1.2 Mounting over a washing machine

- A fixing device should be used between the two machines when installing the dryer above a washing machine. The fitting device must be installed by the authorized service agent.
- Total weight of the washing machine and the dryer -with full load- when they are placed on top of each other reaches to approx. 180 kilograms. Place the products on a solid floor that has sufficient load carrying capacity!



Washing machine cannot be placed on the dryer. Pay attention to the above warnings during the installation on your washing machine.

Installation Table for Washing Machine and Dryer

Dryer Depth	Washing Machine Depth						
	62cm	60 cm	54 cm	50 cm	49 cm	45 cm	40 cm
54 cm	Can be installed	Can be installed	Can be installed	Can be installed	Can be installed	Can be installed	Cannot be installed
60 cm	Can be installed	Can be installed	Can be installed	Can be installed	Can be installed	Cannot be installed	Cannot be installed

Important instructions for safety and environment

1.3 Intended use

- Dryer has been designed for domestic use. It is not suitable for commercial use and it must not be used out of its intended use.
- Use the dryer only for drying laundry that are marked accordingly.
- The manufacturer waives any responsibility arisen from incorrect usage or transportation.
- The service life of the dryer that you purchased is 10 years. During this period, original spare parts will be available to operate the dryer properly.

1.4 Child safety

- Packaging materials are dangerous for the children. Keep packaging materials away from children.
- Electrical products are dangerous for the children. Keep children away from the product when it is operating. Do not let them tamper with the dryer. Use the child-proof lock in order to prevent the children to tamper with the dryer.



Child-proof lock is on the control panel. **(See Child lock)**

- Keep loading door closed even when the dryer is not in use.

Important instructions for safety and environment

1.5 Compliance with the WEEE regulation and disposing of the waste product



This product complies with EU WEEE Directive (2012/19/EU). This product bears a classification symbol for waste electrical and electronic equipment (WEEE).

This product has been manufactured with high quality parts and materials which can be reused and are suitable for recycling. Do not dispose of the waste product with normal domestic and other wastes at the end of its service life. Take it to the collection center for the recycling of electrical and electronic equipment. Please consult your local authorities to learn about these collection centers.

1.6 Compliance with RoHS Directive:

The product you have purchased complies with EU RoHS Directive (2011/65/EU). It does not contain harmful and prohibited materials specified in the Directive.

1.7 Package information

Packaging materials of the product are manufactured from recyclable materials in accordance with our National Environment Regulations. Do not dispose of the packaging materials together with the domestic or other wastes. Take them to the packaging material collection points designated by the local authorities.

Please visit the following website to get more information on the product.

<http://www.beko.com>

Important instructions for safety and environment

1.8 Technical Specifications

EN

Height (Min. / Max.)	84,6 cm / 86,6 cm*
Width	59,5 cm
Depth	54 cm
Capacity (max.)	7 kg**
Net weight (plastic front door usage)	36 kg
Net weight (glass front door usage)	38 kg
Voltage	See type label***
Rated power input	
Model code	

* Min. height: Height with adjustable feet are closed.

Max. height: Height with adjustable feet are opened maximum.

** Dry laundry weight before washing.

*** Type label is located behind the loading door.



Technical specifications of the dryer are subject to specification without notice to improve the quality of the product.



Figures in this manual are schematic and may not match the product exactly.



Values stated on markers on the dryer or in the other published documentation accompanying with the dryer are obtained in laboratory in accordance with the relevant standards. Depending on operational and environmental conditions of the dryer, these values may vary.

2 Your Dryer

2.1 Package Contents

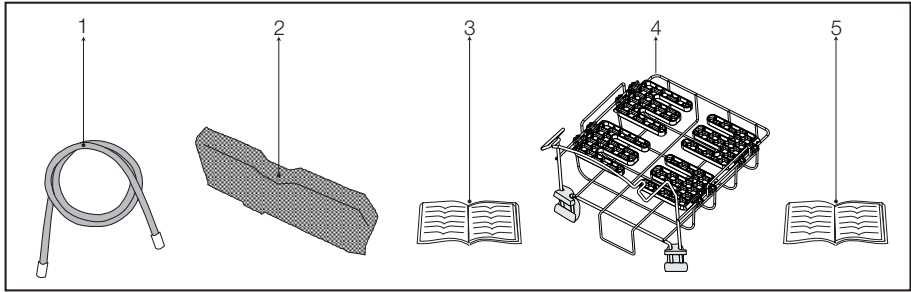

1. Water drain hose *
2. Filter drawer spare sponge*
3. User Manual
4. Drying basket*
5. Drying basket user manual*

*It can be supplied with your machine depending on its model.

3 Installation

Before the calling the nearest Authorized Service for the installation of the dryer, ensure that electrical installation and water drain is appropriate referring to the user's manual. **(See 3.3 Connecting to the drain and 3.5 Electrical connection)** If they are not suitable, contact a qualified electrician and technician to make necessary arrangements.



Preparation of the dryer's location as well as the electrical and waste water installations is under customer's responsibility.



Prior to installation, visually check if the dryer has any defects on it. If the drier is damaged, do not have it installed. Damaged products cause risks for your safety.

3.1 Appropriate installation location

Install the dryer on a stable and level surface.

Dryer is heavy. Do not move it by yourself.

- Operate your dryer in a well ventilated, dust-free environment.
- The gap between the dryer and the surface should not be reduced by the materials such as carpet, wood and tape.
- Do not cover the ventilation grills of the dryer.
- There must not be a lockable, sliding or hinged door that may block the opening of the loading door in the place where your dryer is to be installed.
- Once the dryer is installed, it should stay at the same place where its connections have been made. When installing the dryer, make sure that its rear wall does not touch anywhere (tap, socket, etc.).
- Place the dryer at least 1 cm away from the edges of other furniture.
- Your dryer can be operated at temperatures between +5°C and +35°C. If the operating conditions fall outside of this range, operation of the dryer will be adversely affected and it can get damaged.
- The rear surface of the tumble dryer shall be placed against a wall.



Do not place the dryer on the power cable.

3.2 Removing the transportation safety assembly



Remove the transportation safety assembly before using the dryer for the first time.

Open the loading door.

There is a nylon bag inside the drum that contains a piece of styrofoam. Hold it from its section marked with **XX XX**.

Pull the nylon towards yourself and remove the transportation safety assembly.

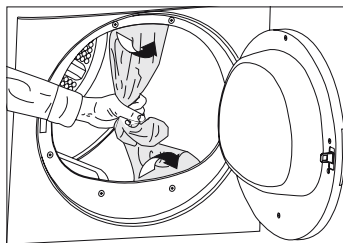

Check that no part of the transportation safety assembly remains inside the drum.

3.3 Connecting to the drain

In products equipped with condenser unit, water accumulates in the water tank during the drying cycle. You should drain accumulated water after each drying cycle.

You can directly drain accumulated water through the water drain hose supplied with the product instead of periodically draining the water collected in the water tank.

Connecting the water drain hose

- 1-2** Pull hose at the behind of the dryer by hand in order to disconnect it from where it is connected. Do not use any tools to remove the hose.
- 3** Connect one end of the drain hose supplied with the dryer to the connection point from where you removed the hose of the product in previous step.
- 4** Connect the other end of the drain hose directly to the wastewater drain or to the washbasin.

Installation

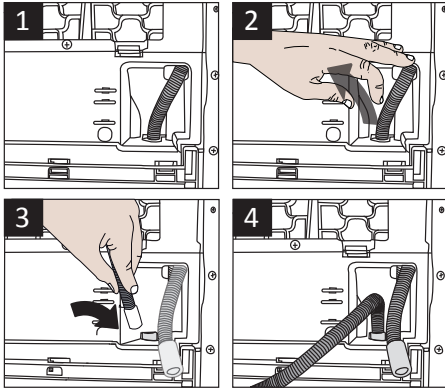

Hose connection should be made in a safe manner. Your drain house will be flooded if the hose comes out of its housing during water discharge.



Water drain hose should be attached to a height of maximum 80 cm.



Make sure that the water drain hose is not stepped on and it is not folded between the drain and the machine.

3.5 Electrical connection

For specific instructions for electrical connection required during installation (see **1.1.1 Electrical Safety**)

3.6 Transportation of the dryer

Unplug the dryer before transporting it.

Drain all water that has remained in the dryer.

If direct water drain connection is made, then remove the hose connections.



We recommend carrying the dryer in upright position. If it is not possible to carry the machine in the upright position, we recommend carrying it by tilting towards the right side when looked from the front.

3.7 Changing the illumination lamp

In case an illumination lamp is used in your laundry dryer. To change the Bulb/LED used for illumination of your tumble dryer, call your Authorized Service. The lamp(s) used in this appliance is not suitable for household room illumination. The intended purpose of this lamp is to assist the user to place laundry in the tumble dryer in a comfortable way.

3.4 Adjusting the feet

In order to ensure that the dryer operates more silently and vibration-free, it must stand level and balanced on its feet. Balance the machine by adjusting the feet.

Turn the feet to left or right until the dryer stands level and firmly.

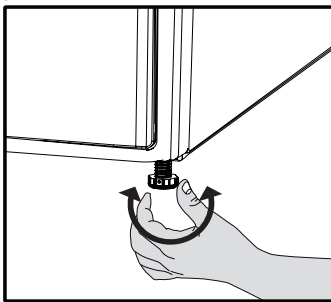

Never unscrew the adjustable feet from their housings.

4 Preparation

4.1 Laundry suitable for drying in the dryer

Always obey the instructions given on the garment tags. Dry only the laundry having a label stating that they are suitable for drying in a dryer and make sure that you select the appropriate programme.

LAUNDRY DRYING SYMBOLS																					
	Drying Symbols		Suitable for dryer		No Iron		Sensitive / Delicate dry		Do not dry with dryer		Do not dry		Do not dry-clean								
	Drying Settings		At any temperature		At high temperature		At medium temperature		At low temperature		Without heating		Hang to dry		Lay to dry		Hang wet to dry		Lay in shadow to dry		Dry-cleanable
	Iron -				Iron at high temperature		Iron at medium temperature		Iron at low temperature		Do not iron		Iron without steam								
IRON	Dry or Steam																				
	Maximum temperature			200 °C		150 °C		110 °C													

4.2 Laundry not suitable for drying in the dryer



Delicate embroidered fabrics, woolen, silk garments, delicate and valuable fabrics, airtight items and tulle curtains are not suitable for machine drying.

4.3 Preparing laundry for drying

- Laundry may be tangled with each other after washing. Separate the laundry items before placing them into the dryer.
- Dry garments having metal accessories such as zippers, inside out.
- Fasten the zippers, hooks and buckles and button sheets.

4.4 Things to be done for energy saving

Following information will help you use the dryer in an ecological and energy-efficient manner.

- Spin your laundry at the highest speed possible when washing them. Thus, the drying time is shortened and energy consumption is reduced.
- Sort out the laundry depending on their type and thickness. Dry the same type of laundry together. For example thin kitchen towels and table clothes dries earlier than thick bathroom towels.
- Follow the instructions in the user manual for programme selection.
- Do not open the loading door of the machine during drying unless necessary. If you must certainly open the loading door, do not to keep it open for a long time.
- Do not add wet laundry while the dryer is in operation
- Clean the lint filter before or after each drying cycle. **(See 6.1 in Maintenance and cleaning)**

Preparation

- Clean the condenser regularly at least once every month or after every 30 drying cycles. **(See 6.4 in Maintenance and cleaning)**
- Ventilate the room, where the dryer is located, well during drying.

4.5 Correct load capacity

Follow the instructions in the “Programme selection and consumption table”. Do not load more than the capacity values stated in the table.

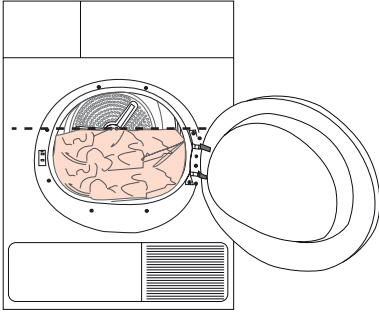

It is not recommended to load the dryer with laundry exceeding the level indicated in the figure. Drying performance will degrade when the machine is overloaded. Furthermore, dryer and the laundry can get damaged.

Following weights are given as examples.

Laundry	Approximate weights (g)*
Cotton quit covers (double)	1500
Cotton quit covers (single)	1000
Bed sheets (double)	500
Bed sheets (single)	350
Large tablecloths	700
Small tablecloths	250
Tea napkins	100
Bath towels	700
Hand towels	350
Blouses	150
Cotton shirts	300
Shirts	200
Cotton dresses	500
Dresses	350
Jeans	700
Handkerchiefs (10 pieces)	100
T-Shirts	125

*Dry laundry weight before washing.

5 Operating the product

5.1 Control panel

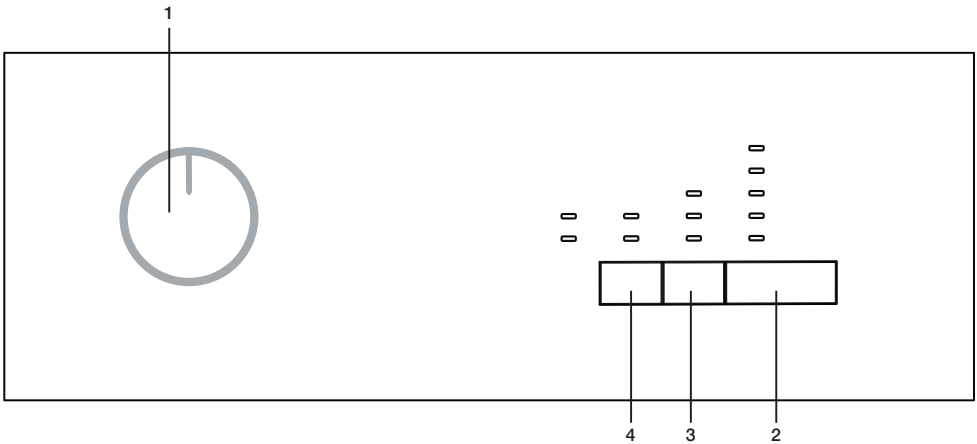

1. On/Off/Program selection button
2. Start/Pause button
3. Delay time button
4. Audio alarm level button

5.2 Screen symbols

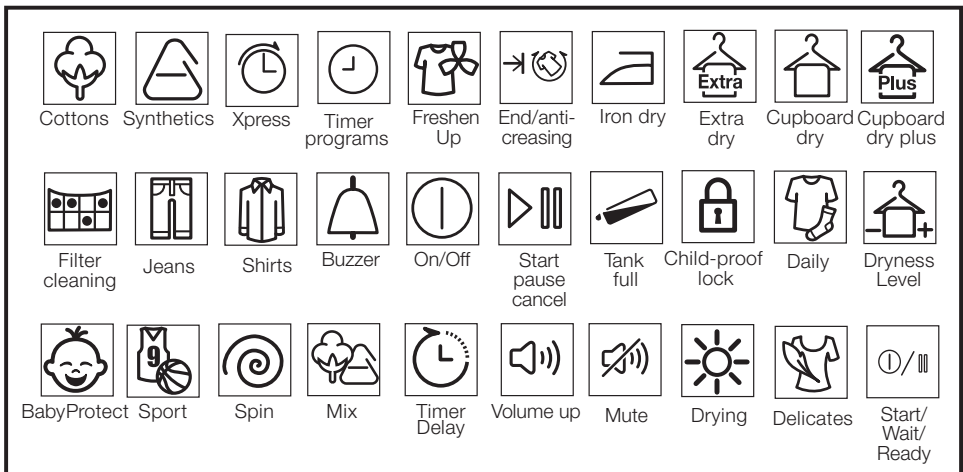

Operating the product

5.3 Preparation of Tumble Dryer

- Plug in the tumble dryer.
- Open the loading door.
- Place the laundry into the tumble dryer without overloading.
- Push and close the loading door.



Take care not to trap any laundry inside the loading door.

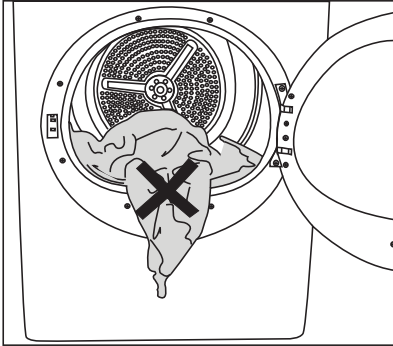

- When you select the desired program by using On/off/program selection button, the machine will turn on.

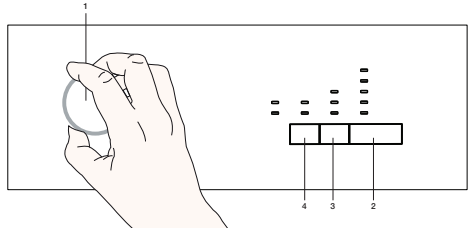

Selection of program by using On/off/program selection button doesn't mean that the program has been started. Press the Start/Pause button to start the program.

5.4 Program selection

There are 15 programs included in your tumble drier.

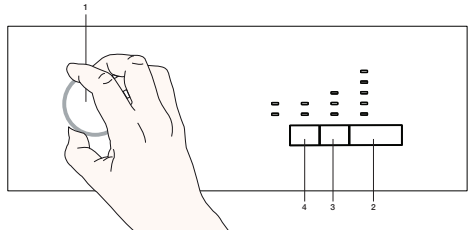

- Program selection and consumption table have been given in the order that might be mostly preferred by users.

Operating the product

5.5 Program selection and consumption table

Programs	Program Description	Capacity (kg)	Spin Speed in Washing Machine (rpm)	Drying Time (min)
Cotton Cupboard dry	You may dry all your cotton laundry in this program. (T-shirt, pants, pyjamas, baby clothes, underwear, linen, etc.) You can put your laundry in the wardrobe without ironing.	7	1000	116
Cotton Cupboard dry +	You may use this program for extra dryness in thick laundry such as pants, tracksuit. You can put your laundry in the wardrobe without ironing.	7	1000	120
Cotton Iron Dry	You may dry your cotton laundry to be ironed in this program to have them slightly damp for ease of ironing. (Shirt, T-shirt, tablecloth, etc.)	7	1000	90
Cotton Extra Dry	You may dry your thick cotton laundry in this program such as towels, bathrobe, etc. You can put your laundry in the wardrobe without ironing.	7	1000	124
Synthetic Cupboard dry	You may dry all your synthetic laundry in this program. (Shirt, T-shirt, underwear, tablecloth, etc.) You can put your laundry in the wardrobe without ironing.	3.5	800	45
Synthetic Iron Dry	You may dry your synthetic laundry to be ironed in this program to have them slightly damp for ease of ironing. (Shirt, T-shirt, tablecloth, etc.)	3.5	800	35
Jeans	You may dry denim pants, skirts, shirts or jackets in this program.	4	1200	80
Daily	You may dry both your cotton and synthetic daily laundry in this program.	1.5	600	59
Shirt	It dries the shirts in a more sensitive manner, and causes less creasing and easier ironing.	1.5	1200	40
Sport	You may dry your sports clothes that are appropriate for tumble drying in this program.	4	1000	92
Delicates	You may dry your delicate laundry or laundry with hand wash symbol (silk blouses, thin underwear, etc.) at low temperature in this program.	2	600	40
Freshen up	It just provides airing for 10 minutes without any hot air. You can air the cotton and linen laundry that are kept closed for a long time, and eliminate the odour in them.	-	-	10
Timer programmes	You may select from time programs between 10 and 20 and 40 minutes to achieve the desired drying level at low temperature. In this program, tumble drier's operation lasts for the set time independently from the dryness of laundry.	-	-	-

Operating the product

* : Energy Label standard program (EN 61121:2012) All the filters must be cleaned prior to test series. All values in the table have been specified as per the EN 61121:2012 standard. Consumption values may vary from the values in the table depending on the variances in laundry type, spin speed, ambient conditions, and voltage values.

Energy consumption values				
Programs	Capacity(kg)	Spin Speed in Washing Machine (rpm)	Approximate residual moisture content	Energy consumption value (kWh)
Cotton Wardrobe Dryness*	7	1000	60%	4,17
Cotton Iron Dryness	7	1000	60%	3,25
Synthetic Wardrobe Dryness	3,5	800	40%	1,42
Power consumption of the off-mode for the standart cotton programme at full load, PO (W)				0,5
Power consumption of the left-on mode for the standart cotton programme at full load, PL (W)				1,0



„Cotton cupboard dry programme“ used at full and partial load is the standard drying programme to which the information in the label and the fiche relates, that this programme is suitable for drying normal wet cotton laundry and that it is the most efficient programme in terms of energy consumption for cotton.



To obtain better results from your dryer, your laundry must be washed at suitable programs and spun at the recommended speed in the washing machine.



There may be a little moisture on the shirts at the end of the programme. We recommend you not to leave the shirts in the dryer.

Operating the product

5.6 Auxiliary functions

Audio alarm

An audio alarm is heard when the program is completed in the tumble drier. If you do not want to hear the audio alarm, please press the "Audio Alarm" button. When you press the audio alarm button, the light turns on and you hear no alarm at the completion of program.



You may select this function before or after the program starts.

5.7 Warning indicators



Warning indicators may vary depending on the model of your tumble drier.

Filter cleaning

The warning indicator turns on to show that the filter needs to be cleaned.

Water tank

The warning indicator turns on to show that the water tank needs to be drained.

If the water tank fills during the operation of program, warning indicator flashes and machine pauses. In such a case, drain the water in water tank and start the program by pressing Start/Pause button. Warning indicator turns off and program is resumed.

Delay time

If you prefer to dry your laundry after a certain period of time, you may delay the start of program up to 3, 6 or 9 hours thanks to the delay function.

Open the loading door, and put the laundry in.

Select the drying program.

- By pressing the Delay time selection button, set the desired delay time. When the Delay time button is pressed one more time, 3-hour delay is selected and relevant indicator light turns on. When the same button is pressed again, 6-hour delay is selected, and one more pressing causes 9-hour delay. If the delay time button is pressed once more, the delay is cancelled.
- After the selection of Delay time, delayed operation is started for the selected program by pressing "Start/Pause" button.



Laundry may be added or removed during the delay time. At the end of countdown for Delay Time, Delay Time warning indicator turns off and drying starts.

Changing the delay time

If you want to change the time during countdown:

- Cancel the program by turning On/off/program selection button. Repeat the Delay time selection process after selecting the desired program.

Canceling the delay time function

If you want to cancel the delay time countdown and start the program immediately:

- Cancel the program by turning On/off/program selection button. Press the "Start/Pause" button after selecting the desired program.

5.7 Starting the program

Start the program by pressing the Start/Pause button. Indicators of Start/Pause/Ready and Drying turn on to show that program has started.

5.8 Child Lock

There is a child lock in the tumble drier that prevents the program flow from being affected when the buttons are pressed during operation of program. When the Child Lock is active, all buttons on the panel are disabled except for the On/off/program selection button.

In order to activate the child lock, press and hold the Delay time and Audio alarm buttons spontaneously for 3 seconds.

Once the program is completed, the child lock must be disabled to start a new program or intervene in the program. Press and hold the same buttons for 3 seconds to disable the child lock.



When the Child Lock is enabled, child lock warning indicator on the display turns on.



Child lock is disabled when the tumble drier is turned off and turned on again by using the On/off/program selection button.



Child lock is disabled when the machine is turned off and turned on again by using the On/off/program selection button.

When the child lock is active:

If the position of program selection button is changed while the tumble drier is running or paused, indicator symbols do not change.

Operating the product



When the program selection switch is turned while the tumble drier is running and child lock is active, two beeps are heard. If the child lock is cancelled without restoring the program selection to switch to its previous position, program is ended because the position of program selection switch is changed.

5.9 Changing the program after starting

After the tumble drier starts running, you may dry your laundry in a different program by changing the selected program.

- For instance, in order to select Extra Dry instead of Iron Dryness program, select the Extra Dry program by turning the On/off/program selection button.

Start the program by pressing the Start/Pause button.

Adding or removing laundry during pause

If you want to add or remove laundry after the drying program has started:

- Put the tumble drier into Pause position by pressing the Start/Pause button. Drying process stops.
- Open the loading door in Pause position, and close the door after adding or removing laundry.
- Start the program by pressing the Start/Pause button.



The process of adding laundry after the start of drying process might lead to mixing of wet laundry with the dried laundry inside the tumble drier and some damp laundry at the end of process.



Laundry adding and removing process can be repeated as many times as desired during drying. But this process leads to extension in the program time and increase in energy consumption since it will repeatedly interrupt the drying process. Therefore, it is recommended to add laundry before starting the program.



If a new program is selected by changing the position of program selection button while the tumble drier is paused, the running program ends.



Do not contact the inner surface of drum while adding or removing laundry during a running program. Surface of drum is hot.

5.10 Cancelling the program

When you want to cancel the program and end the drying process for any reason after the tumble drier has started operation, the program is cancelled by turning the On/off/program selection button.



WARNING: When you cancel the program during the operation of tumble drier, inner part will be extremely hot; therefore, allow it to cool down by running the airing program.

5.11 End of program

At the end of program, Fibre Filter Cleaning and Water Tank warning symbols on the program monitoring indicator turn on. Loading door can be opened, and the tumble drier will be ready for a second operation.

In order to turn off the tumble drier, put the On/Off/Program selection button in On/Off position.



When the laundry isn't removed after the end of program, 2-hour anti-creasing function is enabled in order to prevent creasing of laundry. Program spins the laundry at intervals of 10 minutes, and prevents creasing.



Clean the fibre filter after each drying. (See: "Fibre filter and Loading door inner surface")



Drain the water tank after each drying. (See: "Draining the water tank")

6 Maintenance and cleaning

Service life of product extends and frequently experienced problems will be reduced if it is cleaned at regular intervals.

6.1 Cleaning Lint Filter / Loading Door Inner Surface

Lint and fiber released from the laundry to the air during the drying cycle are collected in the Lint Filter.



Such fiber and lint are generally formed during wearing and washing.



Always clean the lint filter and the inner surfaces of the loading door after each drying process.



You can clean the lint filter housing with a vacuum cleaner.

To clean the lint filter:

- Open the loading door.
- Remove the lint filter by pulling it up and open the lint filter.
- Clean lint, fiber, and cotton raveling by hand or with a soft piece of cloth.
- Close the lint filter and place it back into its housing.

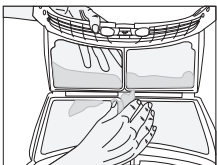
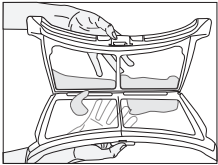
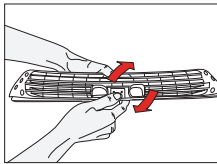
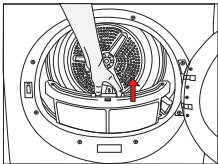

- A layer can build up on the filter pores that can cause clogging of the filter after using the dryer for a while. Wash the lint filter with warm water to remove the layer that builds up on the lint filter surface. Dry the lint filter completely before reinstalling it.

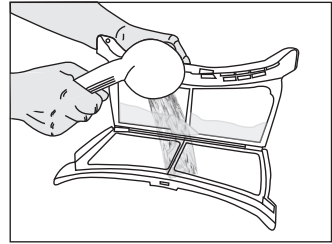

- Clean the entire inner surface of the loading door and loading door gasket with a soft damp cloth.

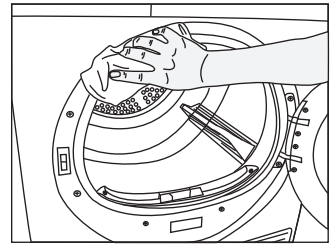
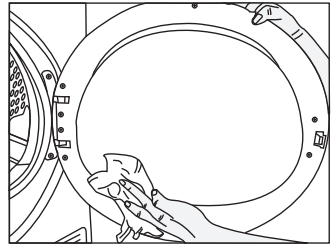

6.2 Cleaning the sensor

There are dampness sensors in the dryer that detect whether the laundry is dry or not.

To clean the sensors:

- Open the loading door of the dryer.
- Allow the machine to cool down if it is still hot due to the drying process.
- Wipe the metal surfaces of the sensor with a soft cloth, dampened with vinegar and dry them.



Clean metal surfaces of the sensors 4 times a year.



Do not use metal tools when cleaning metal surfaces of the sensors.

Maintenance and cleaning



Never use solvents, cleaning agents or similar substances for cleaning due to the risk of fire and explosion!

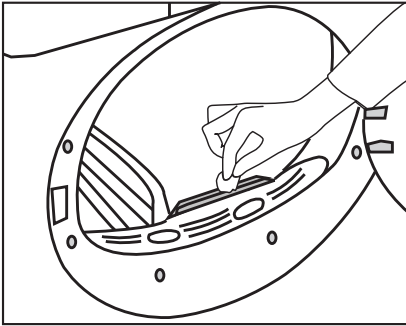

- Drain the water in the tank.

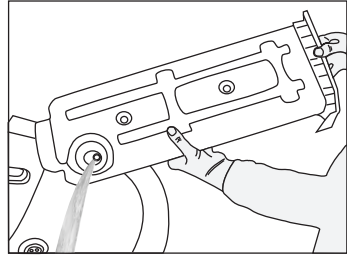

- If there is lint accumulation in the funnel of the water tank, clean it under running water.
- Place the water tank into its seat.



If the direct water draining is used as an option, there is no need to empty the water tank.

6.3 Draining the water tank

Dampness of the laundry is removed and condensed during drying process and the water that arise accumulates in the water tank. Drain the water tank after each drying cycle.



Condensed water is not drinkable!



Never remove the water tank when the program is running!

If you forget to drain the water tank, the machine will stop during the subsequent drying cycles when the water tank is full and the Water Tank warning symbol will flash. If this is the case, drain the water tank and press **Start / Pause** button to resume the drying cycle. To drain the water tank:

Pull the drawer and remove the water tank carefully.

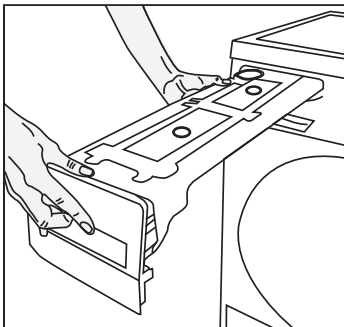

6.4 Cleaning the condenser;

Hot and humid air in the condenser is cooled with the cold air from the room. Thus, the humid air circulating in your dryer is condensed and then pumped into the tank.



Clean the condenser after every 30 drying cycles or once a month.

To clean the condenser:

1. If a drying process has been carried out, open the door of the machine and wait until it cools down.

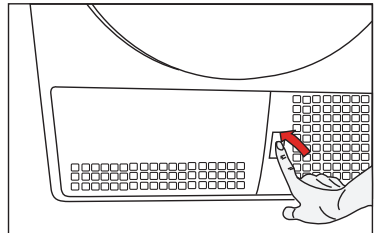

Maintenance and cleaning

2. Unlock the 2 condenser locks after opening the kick plate.

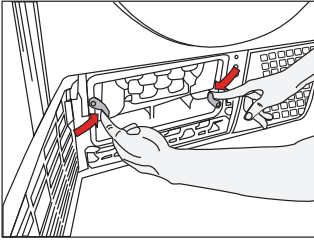

6. Close the kick plate cover.

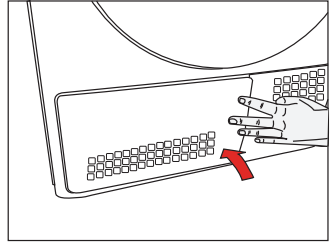

3. Pull out the condenser.

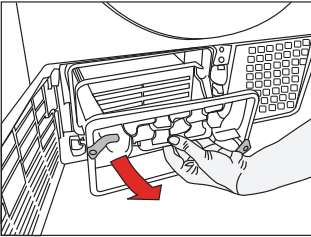

4. Clean the condenser by applying pressurized water with a shower armature and wait until the water drains.

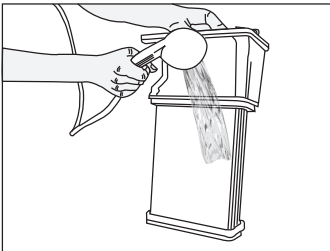

5. Place the condenser in its housing. Fasten the 2 locks and make sure that they are seated securely.

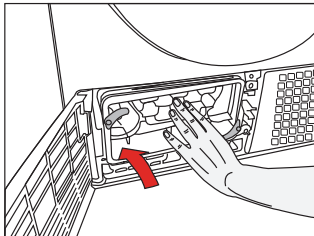

7 Troubleshooting

Drying process lasts for a long time.

- Pores of the fibre filter might be clogged. >>> *Wash the filter with warm water.*
- Condenser might be clogged. >>> *Wash the condenser.*
- Ventilation grills at the front of machine might be blocked. >>> *Remove any items in front of the ventilation grills that block ventilation.*
- Ventilation might be inadequate if the installation area is very small. >>> *Open the windows and doors in order to prevent excessive increase in room temperature.*
- There might be furring on the damp sensor. >>> *Clean the damp sensor.*
- Laundry might be overloaded. >>> *Do not overload the tumble drier.*
- Laundry might not have been adequately spun. >>> *Increase the rpm of tumble drier.*

Laundry is still wet at the end of drying.



Hot laundry unloaded at the end of drying feel wetter than they really are.

- You may not have used a program suitable for laundry type.>>> *Check the maintenance labels on the laundry and select a program suitable for their type, or use the time programs additionally.*
- Pores of the fibre filter might be clogged. >>> *Wash the filter with warm water.*
- Condenser might be clogged. >>> *Wash the condenser.*
- Laundry might be overloaded. >>> *Do not overload the tumble drier.*
- Laundry might not have been adequately spun. >>> *Increase the rpm of tumble drier.*

Tumble drier does not turn on or program cannot be started. Tumble drier does not activate when set.

- The power cord might not be plugged in. >>> *Make sure the power cord is plugged in.*
- Loading door might be open. >>> *Make sure that the loading door is properly closed.*
- You may not have set the program or pressed the Start/Pause button. >>> *Make sure that you have set the program and it is not in Pause position.*
- Child lock might be active. >>> *Disable the child lock.*

Program was interrupted for no reason.

- Loading door might not be properly closed. >>> *Make sure that the loading door is properly closed.*
- A power cut might have occurred. >>> *Press the Start/ Pause button to start the program.*
- Water tank might be full. >>> *Drain the water tank.*

Laundry is shrunk, felt or worn out.

- You may not have used a program suitable for laundry type. >>> *Check the maintenance labels on the laundry and select a program suitable for their type.*

The lighting inside the tumble drier does not turn on. (In models with lamps)

- You may not have turned on the tumble drier by using On/Off/Cancel button. >>> *Make sure that the tumble drier is at 'on' position.*
- Lamp might be broken. >>> *Contact the Authorized Service for the replacement of lamp.*

Filter cleaning warning led is on.

- Fibre filter might not have been cleaned. >>> *Clean the filter.*

Filter cleaning warning led flashes.

- Filter bearing might be clogged with fibre. >>> *Clean the filter bearing.*
- There might be a layer in the filter pores that causes clogging. >>> *Wash the filter with warm water.*
- Condenser might be clogged. >>> *Wash the condenser.*

Troubleshooting

Water is leaking from the condenser cover.

- There might be fibre build-up inside the loading door and on the surfaces of loading door gasket. >>> *Clean the inner surfaces of loading door and surfaces of loading door gasket.*

Loading door opens itself.

- Loading door might not be properly closed. >>> *Push the loading door until you hear the closing sound.*

Water tank warning led is on/flashs.

- Water tank might be full. >>> *Drain the water tank.*
- Water drain hose might be folded. >>> *Check the water drain hose if the product is directly connected to the water outlet.*



If you cannot eliminate the problem despite following these instructions, please contact the vendor that sold you the product or an Authorized Service. Do not try to repair the product yourself

8 Electrical Connection

Make sure that you have an earthed power outlet socket rated at 13 amps (minimum).

Attention!

If you use your dryer as built-in, the socket must be reachable after installation, or a separate switch (which can disconnect the two poles) must be used in the installation. Check for suitability. For a permanent connection, a master switch with at least 3mm contact clearance and minimum 13 A rating must be used.

Electrical requirements

Before you insert the plug into the wall socket make sure that the voltage and the frequency shown in the rating label corresponds to your electricity supply.

We recommend that this appliance be connected to the mains supply via a suitable switched and fused socket in a readily accessible position.

Should the mains lead of the appliance become damaged or need replacing at any time, it must be replaced by a special purpose made mains lead which can only be obtained from a Authorised Service Agent.

A Warning

This appliance must be earthed

If the fitted moulded plug is not suitable for your socket, then the plug should be cut off and an appropriate plug fitted.

The moulded plug on this appliance incorporates a 13A fuse. Should the fuse need to be replaced an ASTA approved BS1362 fuse of the same rating must be used. Do not forget to refit the fuse cover. In the event of losing the fuse cover, the plug must not be used until a replacement fuse cover has been fitted. Colour of the replacement fuse cover must be the same colour as that visible on the pin face of the plug. Fuse covers are available from any good electrical store.

In order to avoid hazards, damaged supply cord should be replaced by the manufacturer, its service agent or similarly qualified people.

A Important Fitting a different plug

As the colours of the wires in the mains lead of this appliance may not correspond with the coloured markings identifying the terminals on your plug, proceed as follows:

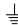
- 1 Connect the green - yellow or green (earth) wire to the terminal in the plug marked 'E' or with the symbol  or coloured green and yellow or green.
- 2 Connect the blue (neutral) wire to the terminal in the plug marked 'N' or coloured black.
- 3 Connect the brown (live) wire to the terminal in the plug marked 'L' or coloured red.

With the alternative plugs a 13A fuse must be fitted either in the plug or adaptor or in the main fuse box. If in doubt contact a qualified electrician.

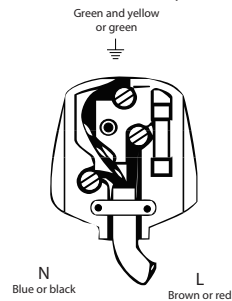

Free Manuals Download Website

<http://myh66.com>

<http://usermanuals.us>

<http://www.somanuals.com>

<http://www.4manuals.cc>

<http://www.manual-lib.com>

<http://www.404manual.com>

<http://www.luxmanual.com>

<http://aubethermostatmanual.com>

Golf course search by state

<http://golfingnear.com>

Email search by domain

<http://emailbydomain.com>

Auto manuals search

<http://auto.somanuals.com>

TV manuals search

<http://tv.somanuals.com>