

Indoor Electric Fireplace

Model No. EF700SP

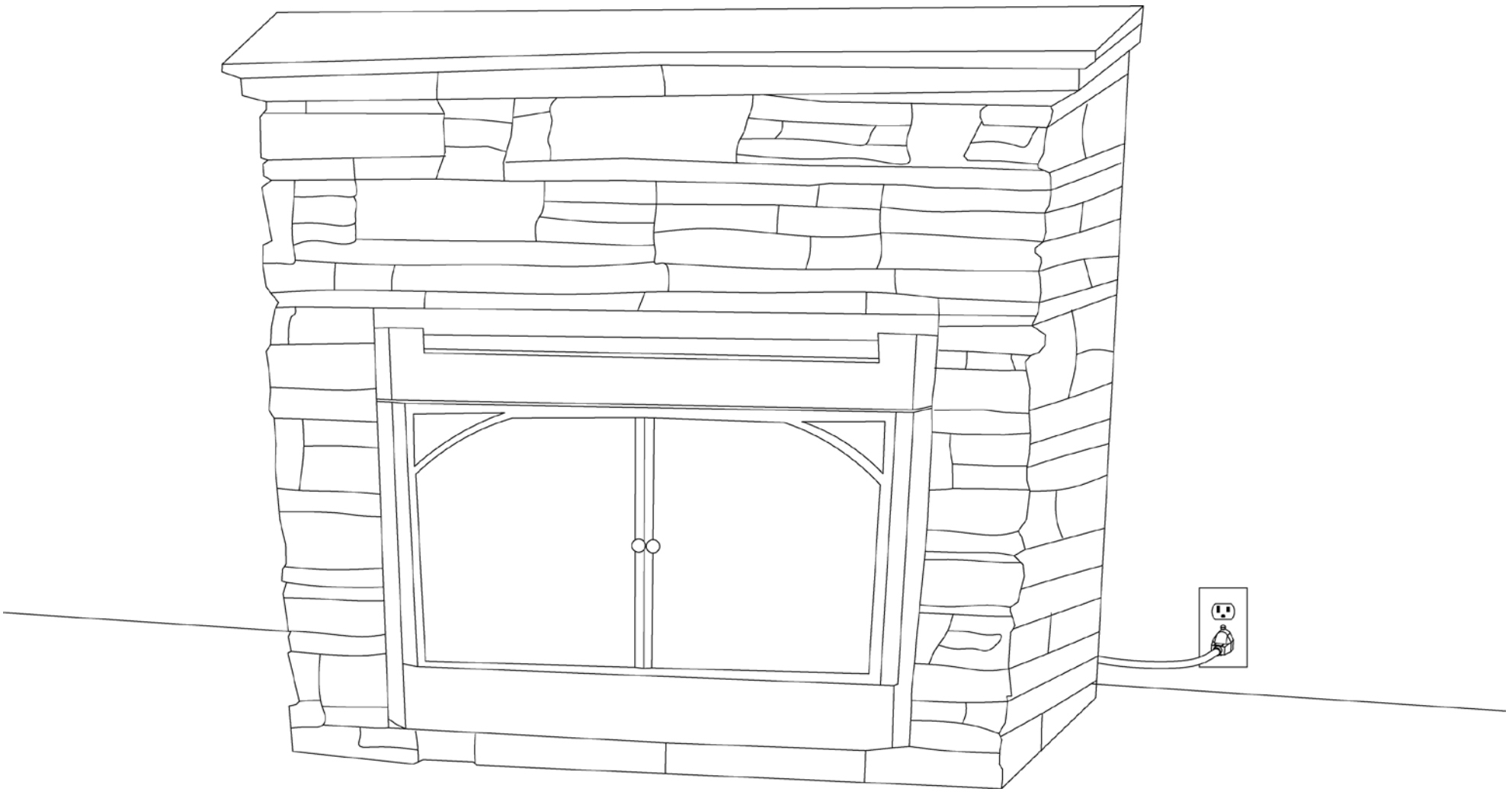

WARNING
FOR YOUR SAFETY:
For Indoor Use Only

WARNING
FOR YOUR SAFETY:

1. Improper installation, adjustment, alteration, service or maintenance can cause injury or property damage.
2. Read the installation, operation, and maintenance instructions thoroughly before installing or servicing this equipment.
3. Failure to follow these instructions could result in fire or explosion, which could cause property damage, personal injury or death.
4. This instruction manual contains important information necessary for the proper assembly and safe use of the appliance.
5. Read and follow all warnings and instructions before assembling and using the appliance.
6. Follow all warnings and instructions when using the appliance.

Danger
Do NOT use electric fireplace for cooking.
NOT to be used in or on boats or recreational vehicles.

Table of Contents

Important Safeguards	Page 2
Exploded View & Hardware	3
Operating Instructions	4
Before Turning "ON"	4
Turning "ON"	4
While Electric fireplace is "ON"	4
Using Remote Control	4
Turning "OFF"	4
Cleaning and Care	4
Cleaning Surfaces	4
Maintenance	4
Storage	5
Between Uses	5
During Periods of Extended Inactivity or When Transporting	5
Product Registration	5
Limited Warranty	5
Specifications	5
Troubleshooting	6

The use and installation of this product must conform to local codes.

Save these instructions for future reference. If you are assembling this unit for someone else, give this manual to him or her to read and save for future reference.

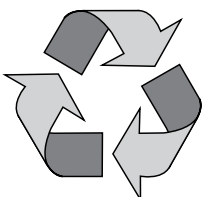

Made from 75% Bagasse
(Environmentally Friendly Sugar
Cane Pulp By-product)



Manufactured in China for: Blue Rhino Global Sourcing, Inc
Winston-Salem, NC USA • 1.800.762.1142, www.bluerhino.com

© Blue Rhino Global Sourcing, Inc. All Rights Reserved
UniFlame® is a Registered Trademark of Blue Rhino Global Sourcing, Inc.. All Rights Reserved.
Download from Wwww.Somanuals.com. All Manuals Search And Download.

IMPORTANT SAFEGUARDS

When using electrical appliances, basic safety precautions should always be followed including the following:

1. Read all instructions before using this electric fireplace.
2. Do not touch hot surfaces.
3. This electric fireplace is hot when in use. To avoid burns, do not let bare skin touch hot surfaces. Keep combustible material such as electrical cords, furniture, papers, clothes, and curtains at least 3 feet (0.9 M) away from the front of the electric fireplace and away from the sides and rear.
4. To protect against electrical shock do not immerse cord, plugs, or heating element in water or other liquids.
5. Close supervision is necessary when any appliance is used by or near children.
6. Unplug from outlet when not in use and before cleaning. Allow to cool before cleaning.
7. Do not operate any electric fireplace with a damaged cord or plug or after the electric fireplace malfunctions, has been dropped or has been damaged in any manner. Return appliance to the nearest authorized service facility for examination, repair, or adjustment.
8. This electric fireplace is not intended for commercial use.
9. The use of accessory attachments not recommended by the appliance manufacturer may cause injuries.
10. Do not let cord touch hot surfaces.
11. Do not place on or near a hot gas or electric burner, or in a heated oven.
13. Do not use appliance for other than intended use.
14. Use only on properly grounded outlet.
15. Do not run cord under carpeting. Do not cover cord with throw rugs, runners, or similar coverings. Arrange cord away from traffic area and where it will not be tripped over.
16. Do not insert or allow foreign objects to enter any ventilation or exhaust opening as this may cause an electric shock or fire, or damage the electric fireplace.

15. SAVE THESE INSTRUCTIONS.

▲ DANGER: Failure to follow the dangers, warning and cautions in this manual may result in serious bodily injury or death, or in a fire or an explosion causing damage to property.

▲ WARNING:

- ▲ This electric fireplace is hot when in use. To avoid burns, do not let bare skin touch hot surfaces.
- ▲ This electric fireplace is for indoor use only.
- ▲ For residential use only. This electric fireplace is NOT for commercial use.
- ▲ This electric fireplace is for use with electricity.
- ▲ This electric fireplace is safety certified for use in the United States and/or Canada only. Do not modify for use in any other location. Modification will result in a safety hazard.
- ▲ Always unplug the electric fireplace if it is not being used.
- ▲ Do not store or use gasoline or other flammable vapors and liquids in the vicinity of this or any other appliance.
- ▲ Avoid the use of an extension cord because the extension cord may overheat and cause a risk of fire.
- ▲ Do not use 16 gauge extension cords. Damage to household wiring and/or fire could result.
- ▲ Longer detachable power-supply cords or extension cords are available and may be used if care is exercised in their use.
- ▲ If a longer detachable power-supply cord or extension cord is used,
 - a. The cord shall be no. 14 AWG minimum size and rated not less than 2,000 watts.
 - b. The marked electrical rating of the cord set or extension cord should be at least as great as the electrical rating of the appliance, and
 - c. The cord should be arranged so that it will not drape over the countertop or tabletop where it can be pulled on by children or tripped over unintentionally.
- ▲ **ELECTRIC SHOCK CAN KILL OR RESULT IN SERIOUS INJURY. TO PREVENT ELECTRICAL SHOCK:**
 - a. Use only with GFI (Ground Fault Interrupter) protected circuit.
 - b. To prevent electric fireplace from being splashed or falling into water, do not use electric fireplace within 10 feet (3.05 m) of sinks or bathtubs.
 - c. Keep electric fireplace and cord dry and out of rain at all times.
 - d. Do not operate electric fireplace that has a damaged cord, plug, or metal probe. Call our customer service for a replacement cord. This cord is made specifically for this electric fireplace.
 - e. Never remove grounding plug, or use with an adapter to two prongs.
 - f. Keep electric plugs off ground, and dry.
 - g. In case of fire, turn electric fireplace "OFF", unplug electric fireplace from outlet, and allow fire to burn out. Do not use water to put out a fire in this or another electrical appliance.
 - h. Do not use water or other liquid spray to clean electric fireplace without first unplugging electric cord.
 - i. Do NOT place the electric fireplace near a bed because objects such as pillows or blankets can fall off the bed and be ignited by the electric fireplace.
 - j. To prevent a possible fire, do not block air intakes or exhaust in any manner. Do not use on soft surfaces, like a bed, where opening may become blocked.
- ▲ If the supply cord is damaged, it must be replaced by the manufacturer, its service agent or similarly qualified persons in order to avoid a hazard.
- ▲ The use of alcohol, prescription or non-prescription drugs may impair the consumer's ability to properly assemble or safely operate the appliance.
- ▲ Never use charcoal, lighter fluid, lava rocks, gasoline, kerosene or alcohol with this product.
- ▲ Do not store or use gasoline or other flammable liquids or vapors within 25 feet (7.62 m) of this appliance.
- ▲ A electric fireplace has hot and arcing or sparking parts inside. Do not use in an explosive atmosphere. Keep electric fireplace area clear and free from combustible materials, gasoline and other flammable vapors and liquids.
- ▲ DO NOT burn wood or other materials in this fireplace.
- ▲ DO NOT use this electric fireplace near any unprotected combustible constructions.
- ▲ Do not alter this electric fireplace in any manner.
- ▲ Do not use the electric fireplace unless it is COMPLETELY assembled and all parts are securely fastened and tightened.
- ▲ DO NOT strike fireplace glass.
- ▲ This electric fireplace should be thoroughly inspected on a regular basis.
- ▲ Do not build this model of electric fireplace in any built-in or slide in construction. Ignoring this warning could cause a fire or an explosion that can damage property and cause serious bodily injury or death.
- ▲ Use only Blue Rhino Global Sourcing, Inc. factory authorized parts. The use of any part that is not factory authorized can be dangerous. This will also void your warranty.
- ▲ Do not use this appliance without reading "Operating Instructions" in this manual.
- ▲ Do not touch metal parts of electric fireplace until it has completely cooled (about 45 min.) to avoid burns, unless you are wearing protective gear (pot holders, gloves, BBQ mittens, etc.).
- ▲ Do not use in or on boats or recreational vehicles.
- ▲ Do not leave a lit electric fireplace unattended, especially keep children and pets away from electric fireplace at all times.
- ▲ Do not attempt to move electric fireplace when in use. Allow the electric fireplace to cool before moving or storing.
- ▲ Keep all electrical cords away from a hot electric fireplace.
- ▲ Always use on a level surface.
- ▲ After a period of storage and/or nonuse, inspect for any abrasion, wear, cuts to the electrical cord.
- ▲ The use of accessory attachments not recommended by the appliance manufacturer may cause injuries.
- ▲ Servicing should be done only while the electric fireplace is disconnected from the power supply.
- ▲ To ensure continued protection against electrical shock, connect only to properly grounded outlets.
- ▲ Do not immerse in water. Disconnect electric cord from outlet before cleaning, servicing and/or removing heating element. To reduce the risk of electric shock, use with GFI protected electric outlet only.
- ▲ High temperatures may be generated under certain abnormal conditions. Do not partially or fully cover or obstruct this electric fireplace.
- ▲ Please use protective gloves when assembling this product.
- ▲ Do not force parts together as this can result in personal injury or damage to the product.
- ▲ Use this electric fireplace only as described in this manual. Any other use not recommended by the manufacturer may cause fire, electrical shock, or injury to persons.
- ▲ Use protective gloves when assembling this product.
- ▲ Do not force parts together as this can result in personal injury or damage to the product.
- ▲ Deaths, serious injury or damage to property may occur if the above is not followed exactly.

Contact 1.800.762.1142 for assistance. Do not return to place of purchase.

Parts List

1	FRP Base	55-05-715
2	Firebox Top Panel	55-05-737
3	Heat Blower	55-05-719
4	Top Glass Panel Frame	55-05-736
5	Decorative Insert (2)	55-05-709
6	Firebox Back Panel	55-05-712
7	Firebox	55-05-711
8	Front Heat Panel Hinge (2)	55-05-714
9	Main Power Support	55-05-724
10	Control Knob (2)	55-05-708
11	Glass Panel (2)	55-05-716
12	Flame Motor	55-05-713
13	Heat Power Support	55-05-722
14	Heat Power Switch	55-05-727
15	Log	55-05-723
16	Heat Panel Insert	55-05-721
17	Heat Panel	55-05-720
18	Center Panel Support	55-05-707
19	Glass Panel Frame	55-05-717
20	Glass Panel Knob (2)	55-05-718
21	Decorative Panel	55-05-710
22	Power Cord	55-05-726
23	Remote Control	55-05-728

Exploded View

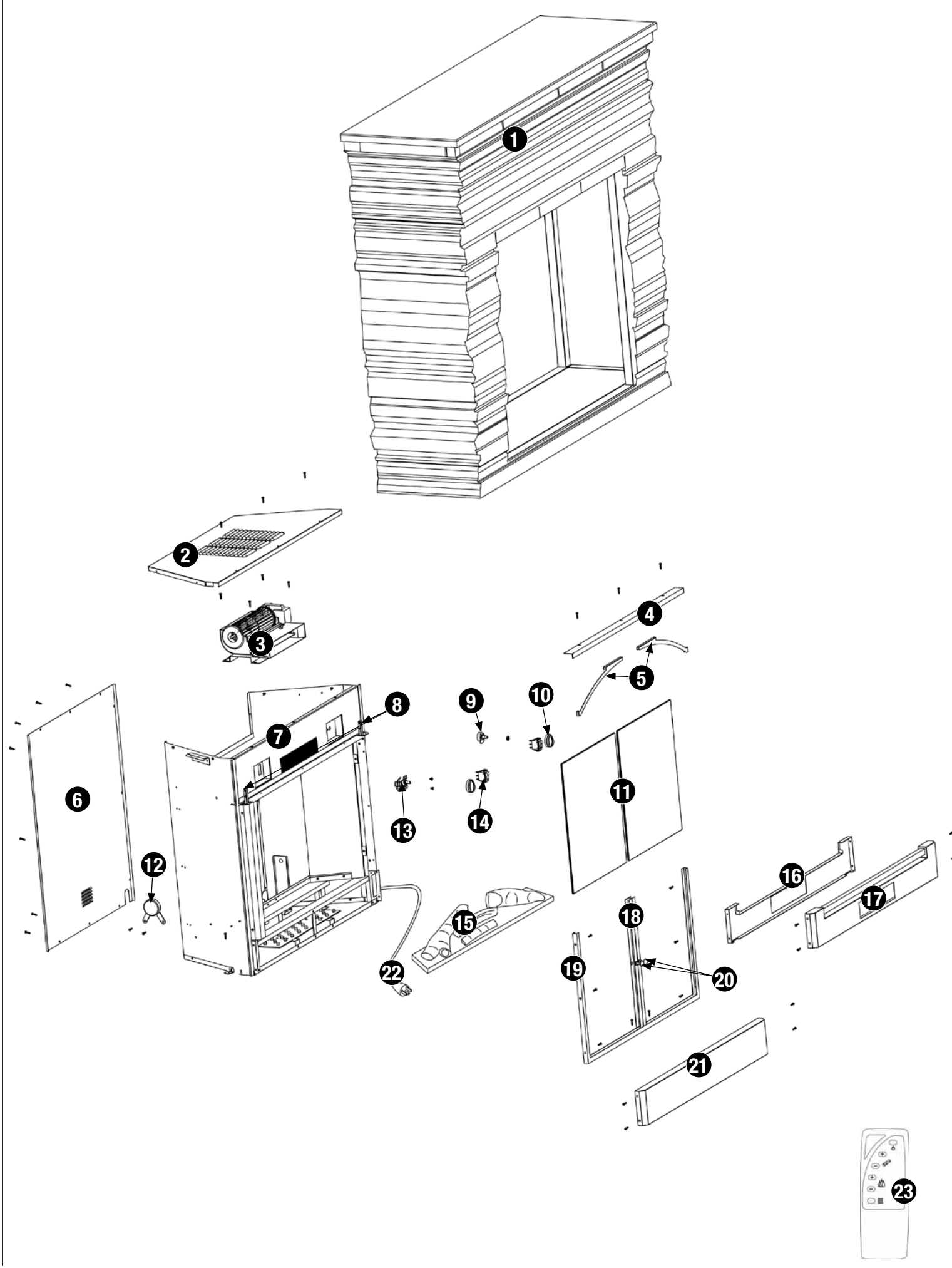

Hardware (Not Included)

A	AA Batteries	AA Batteries	2 pcs
---	--------------	--------------	-------

DO NOT RETURN PRODUCT TO STORE.

For assistance call 1.800.762.1142 toll free. Please have your owner's manual and serial number available for reference.

Note: Two people are required to move the electric fireplace.

Operating Instructions

⚠ Do NOT use an extension cord because the extension cord may overheat and cause a risk of fire.

Before Turning "ON"

1. Make sure all packaging and protective films have been removed from the electric fireplace.
2. Electric fireplace should be thoroughly inspected before each use, and by a qualified service person at least annually.

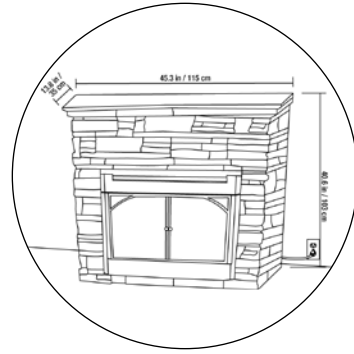

Product size

Turning "ON"

⚠ Caution: Keep electric fireplace area clear and free from combustible materials, gasoline and other flammable vapors and liquids.

⚠ Caution: Do not obstruct the flow of ventilation air.

1. Make sure the main power switch (⏻) is in the "OFF" position. (Illustration 1)
2. Plug the power cord into a dry 120V GFI (Ground Fault Interrupter) 3 plug outlet. (Illustration 2)
3. Push the main power switch to the "ON" position. (Illustration 1).
4. Adjust flame control knob (🔥) to the desired setting.

Note: If you do not want the flame, turn the flame control knob to the twelve (12) o'clock position.

5. To turn the heat on, push the heat switch (🔥) to the "ON" position.
6. Adjust the heat control knob (🌀) to the desired setting.

Note: If you do not want the heat, push the heat switch to the "OFF" position.

Note: Fire log brightness can only be controlled by using the remote. There are not separate controls for the fire log brightness on the control panel.

Note: When the main power is turned on the fire log brightness is factory set to medium brightness.

Using Remote Control

Note: Once the remote is used, the control panel knobs are disabled.

Note: To enable the control panel knobs push the main power switch (⏻) on the control panel to the "OFF" position, wait 5 seconds, then push the main power switch to the "ON" position.

Note: The effective range of the remote control is up to 19.7 ft. (6 m).

1. Insert 2 AAA batteries (NOT INCLUDED) into the back of the remote.

Note: Do NOT mix old and new batteries.

Note: Do NOT mix alkaline, standard (carbon-zinc) or rechargeable (nickel-cadium) batteries.

2. If the electric fireplace is unplugged:
 - a. Make sure the main power switch (⏻) is in the "OFF" position. (Illustration 1)
 - b. Plug the power cord into a dry 120V GFI (Ground Fault Interrupter) 3 plug outlet. (Illustration 2)
 - c. Push the main power switch to the "ON" position. (Illustration 3).

If the electric fireplace is plugged into a dry GFI outlet.

- a. Push the main power switch to the "ON" position. (Illustration 3).
3. To adjust the fire log brightness, press one of the log button (🔥):
 - "+" means more brightness
 - "-" means less brightness.

Note: Fire log brightness can only be controlled by using the remote. There are not separate controls for the fire log brightness on the control panel.

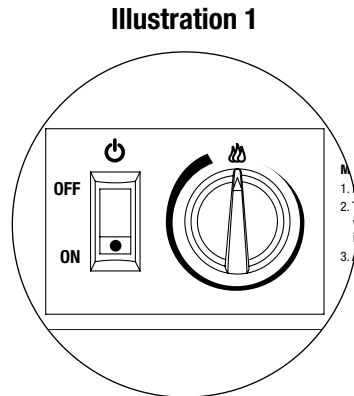

Main Power and flame control.

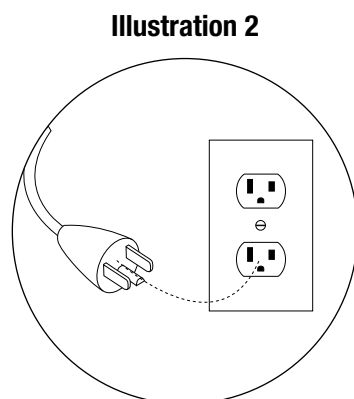

Connecting the power cord to a dry GFI 3 plug outlet.

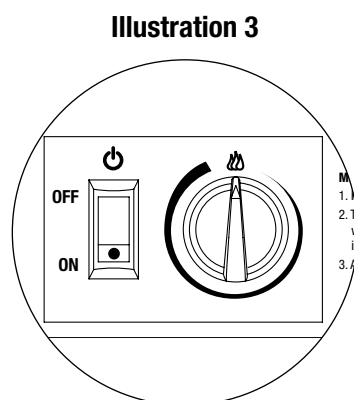

Main Power and flame control.

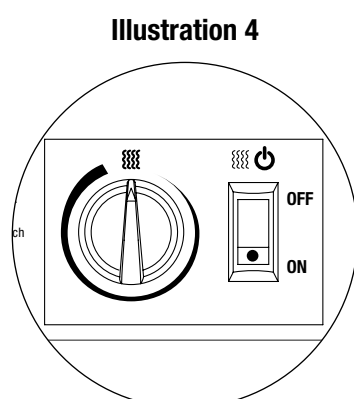

Heat power and heat control.

Note: When the main power is turned on the fire log brightness is factory set to medium brightness.

4. To adjust the flame level, press one of the flame button (🔥):
 - "+" means more brightness
 - "-" means less brightness.
5. To turn heat level "ON" / "OFF", press the heat button (🌀).
 - Note:* the button will turn the heat "ON" to the level set by the heat level control knob.
6. Push the power button (⏻) to turn "OFF".

Note: This does not turn the entire electric fireplace "OFF", the electric fireplace is in the "standby mode".

Illustration 5

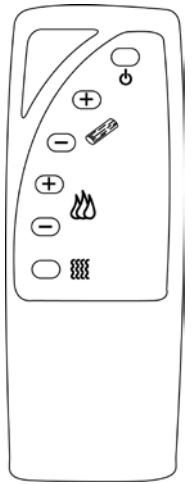

Infrared remote.

Turning "OFF"

1. Push the main power switch (⏻) to the "OFF" position.
2. Unplug the power cord from the wall outlet.

Cleaning and Care

Notices

1. Abrasive cleaners will damage this product.
2. Never use oven cleaner to clean any part of electric fireplace.
3. Do not clean any electric fireplace part in a self cleaning oven. The extreme heat will damage the finish.
4. More frequent cleaning may be required as necessary. It is imperative that control compartment, ventilation openings of the electric fireplace be kept clean.
5. Inspect electric fireplace before each use.
6. Have electric fireplace inspected annually and repairs should be made by a qualified service person.
7. Check electric fireplace immediately if any of the following conditions exist:
 - a. You see sparks around the electrical outlet, power cord or inside the fireplace.
 - b. Any part of the power cord is cut.
 - c. Any strange noise, smell or smoke.
8. Do not paint any part of the electric fireplace firebox.
9. This electric fireplace should be thoroughly checked and cleaned on a regular basis.
10. After a period of storage and/or non use, ventilation obstructions and inspect for any abrasion, wear, cuts to the power cord.

Cleaning Surfaces

1. Wipe surfaces clean with mild dishwashing detergent or baking soda.
2. For stubborn surfaces use a citrus based degreaser and a nylon scrubbing brush.
3. Rinse clean with damp cloth.

Note: While cleaning your unit, be sure to keep the area around the heating element dry at all times. Do not submerge the heating element assembly. If the heating element is submerged in water, do NOT use it. It must be replaced.

Maintenance

To enjoy years of outstanding performance from your electric fireplace, make sure you perform the following maintenance activities on a regular basis:

1. Keep exterior surfaces clean.
2. Air flow must be unobstructed. Keep circulating air passageways clean.

Storage

Between uses:

1. Push the main power switch to the "OFF" position.
2. Unplug the power cord from the wall outlet.
3. If desired, cover electric fireplace to protect exterior surfaces and to help prevent build up in air passages.

▲ Wait until electric fireplace is cool before covering.

During periods of extended inactivity or when transporting:

1. Push the main power switch to the "OFF" position.
2. Unplug the power cord from the wall outlet.
3. If desired, cover electric fireplace to protect exterior surfaces and to help prevent build up in air passages.

▲ Wait until electric fireplace is cool before covering.

Product Registration

For faster warranty service, register your product immediately at www.bluerhino.com or call 1.800.762.1142.

Limited Warranty

Blue Rhino Global Sourcing, Inc ("Vendor") warrants to the original retail purchaser of this product, and to no other person, that if this product is assembled and operated in accordance with the printed instructions accompanying it, then for a period of one (1) year from the date of purchase, all parts in such product shall be free from defects in material and workmanship. Vendor may require reasonable proof of your date of purchase. Therefore, you should retain your sales slip or invoice. This Limited Warranty shall be limited to the repair or replacement of parts, which prove defective under normal use and service and which Vendor shall determine in its reasonable discretion upon examination to be defective. Before returning any parts, you should contact Vendor's Customer Service Department using the contact information listed below. If Vendor confirms, after examination, a defect covered by this Limited Warranty in any returned part, and if Vendor approves the claim, Vendor will replace such defective part without charge. If you return defective parts, transportation charges must be prepaid by you. Vendor will return replacement parts to the original retail purchaser, freight or postage prepaid.

This Limited Warranty does not cover any failures or operating difficulties due to accident, abuse, misuse, alteration, misapplication, improper installation or improper maintenance or service by you or any third party, or failure to perform normal and routine maintenance on the product as set out in this owner's manual. In addition, the Limited Warranty does not cover damage to the finish, such as scratches, dents, discoloration, rust or other weather damage, after purchase.

This Limited Warranty is in lieu of all other express warranties. Vendor disclaims all warranties for products that are purchased from sellers other than authorized retailers or distributors, including the warranty of merchantability or the warranty of fitness for a particular purpose. VENDOR ALSO DISCLAIMS ANY AND ALL IMPLIED WARRANTIES, INCLUDING WITHOUT LIMITATION THE IMPLIED WARRANTIES OF MERCHANTABILITY AND FITNESS FOR A PARTICULAR PURPOSE. VENDOR SHALL HAVE NO LIABILITY TO PURCHASER OR ANY THIRD PARTY FOR ANY SPECIAL, INDIRECT, PUNITIVE, INCIDENTAL, OR CONSEQUENTIAL DAMAGES. Vendor further disclaims any implied or express warranty of, and assumes no responsibility for, defects in workmanship caused by third parties.

This Limited Warranty gives the purchaser specific legal rights; a purchaser may have other rights depending upon where he or she lives. Some jurisdictions do not allow the exclusion or limitation of special, incidental or consequential damages, or limitations on how long a warranty lasts, so the above exclusion and limitations may not apply to everyone.

Vendor does not authorize any person or company to assume for it any other obligation or liability in connection with the sale, installation, use, removal, return, or replacement of its equipment, and no such representations are binding on Vendor.

Blue Rhino Global Sourcing, Inc
Winston-Salem, North Carolina USA
(800) 762-1142

Specifications

Certifications:

CSA International Requirement 22.2 No. 46-M1988
UL 2021 - Standard for Fixed and Location-Dedicated Electric Room Heaters

Fuel:

Electric

Power:

Maximum 1,500 Watts

Voltage:

120V AC

Frequency:

60 Hz

Net Weight:

161 lbs / 73 kgs

Unit Dimensions:

45.3 in L x 13.8 in W x 40.6 in H / 115 cm x 35 cm x 103 cm

Manufacturer:

Blue Rhino Global Sourcing, Inc.

Made In:

China

Troubleshooting

Problem	Possible Cause	Prevention/Cure
Unit does not turn on with the power switch	Main power supply switch is "OFF".	Turn the main power switch (⏻) to "ON" position.
	Circuit breaker has tripped.	Too many appliances on this circuit, be sure that electrical supply for this unit is an individual circuit. Verify unit is installed on a dedicated 15 amp circuit (contact a qualified electrician to check)
	Unit is unplugged from wall outlet.	Plug the power cord into a dry 120V GFI outlet
	Power cord is damaged.	Contact Customer Care Center at 1.800.762.1142 and contact a qualified electrician to replace power cord.
	Power cord prong is loose.	Contact Customer Care Center at 1.800.762.1142 and contact a qualified electrician to replace power cord.
	Loose wiring.	Turn the main power switch (⏻) to "OFF", unplug the unit from the wall, and contact a qualified electrician to check the wiring.
Unit turns off by itself	Another remote control has a similar frequency as other remote controls.	Contact Customer Care Center at 1.800.762.1142
	Radio frequency disturbance from outside sources.	Contact Customer Care Center at 1.800.762.1142
	Defective circuit board.	Contact Customer Care Center at 1.800.762.1142
Heater is on, but no flame or low flame intensity	Flame control knob is at a low setting.	Turn the flame control knob to maximum setting
	Loose wiring.	Turn the main power switch (⏻) to "OFF", unplug the unit from the wall, and contact a qualified electrician to check the wiring.
Flames are frozen	Loose wiring.	Turn the main power switch (⏻) to "OFF", unplug the unit from the wall, and contact a qualified electrician to check the wiring.
	Flame element is not attached to the motor.	Contact Customer Care Center at 1.800.762.1142
	Rotation motor is defective.	Contact Customer Care Center at 1.800.762.1142
Excessive noise in the lower portion of the unit	Flame element is not seated properly.	Contact Customer Care Center at 1.800.762.1142
	Motor is defective.	Contact Customer Care Center at 1.800.762.1142
Excessive noise in the upper portion of the unit	The air intake area or ventilation is blocked.	Turn the main power switch (⏻) to "OFF", unplug the unit from the wall, and check the ventilation areas to make sure they are clear from debris.
	Heater blower is defective.	Contact Customer Care Center at 1.800.762.1142
Heater power switch (⏻) is in the "ON" position, but there is no airflow	The air intake area or ventilation is blocked.	Turn the main power switch (⏻) to "OFF", unplug the unit from the wall, and check the ventilation areas to make sure they are clear from debris.
	The heater system is overheated.	Turn the main power switch (⏻) to "OFF", unplug the unit from the wall, and check the ventilation areas to make sure they are clear from debris. Wait five minutes, then following the "Turning 'ON'" instructions.
	Fan motor is defective.	Contact Customer Care Center at 1.800.762.1142
	Fan blower is not balanced properly.	Contact Customer Care Center at 1.800.762.1142
There is an odor coming from the unit	The unit may emit a slight harmless odor when first prolonged used. This is normal and is caused by the initial heating of the internal parts and will not occur again. If the problem persists or happens after the first prolonged use, contact Customer Care Center at 1.800.762.1142	

If problems can not be corrected by using these methods, please contact 1.800.762.1142 for assistance.

Free Manuals Download Website

<http://myh66.com>

<http://usermanuals.us>

<http://www.somanuals.com>

<http://www.4manuals.cc>

<http://www.manual-lib.com>

<http://www.404manual.com>

<http://www.luxmanual.com>

<http://aubethermostatmanual.com>

Golf course search by state

<http://golfingnear.com>

Email search by domain

<http://emailbydomain.com>

Auto manuals search

<http://auto.somanuals.com>

TV manuals search

<http://tv.somanuals.com>