



Plasmacluster is a trademark
of SHARP Corporation



SJ-PT596R

MODEL
SJ-PT555R
SJ-PT596R

REFRIGERATOR - FREEZER OPERATION MANUAL

CONTENTS

• WARNING	2
• CAUTION	2
• INSTALLATION.....	2
• DESCRIPTION	3
• OPERATION.....	4
• STORING FOOD	5
• CARE AND CLEANING.....	5
• WHAT TO DO BEFORE CALLING FOR SERVICE	6
• SPECIFICATION	7

Household use only
Free standing type

Thank you for buying this SHARP product. Before using your SHARP refrigerator, please read this operation manual to ensure that you gain the maximum benefit from it.

WARNING

- Highly volatile and flammable materials such as ether, petrol, propane gas, adhesive agents and pure alcohol etc. are liable to explode. Do not store these materials in the refrigerator.
- Dust deposited on the power plug may cause fire. Wipe it off carefully.
- Do not attempt to change or modify this refrigerator. This may result in fire, electric shock or injury.
- Ensure that the refrigerator presents no danger to children whilst being stored for disposal. (e.g. remove the door to prevent child entrapment.)
- This refrigerator should be disposed of appropriately. Take the refrigerator to a recycling plant for flammable insulation blowing gases.

CAUTION

- Attention about Power supply:
 - Do not use an extension cord or adapter plug.
 - Make sure that the power cord has not been damaged during installation or moving. If the power plug or cord is loose, do not insert the power plug. There is a risk of electric shock or fire.
 - Disconnect from the mains electricity supply by removing the mains plug from the electricity supply socket. Do not remove by pulling the mains lead. This may cause electric shock or fire.
 - Should the flexible supply cord be damaged, it must be replaced by service agent approved by SHARP as a special cord is required.
- Do not touch the compressor unit or its peripheral parts, as they become extremely hot during operation and the metal edges may cause injury.
- Do not touch foods or metal containers in the freezer compartment with your wet hands. This may cause frostbite.
- Do not place bottled and canned drinks in the freezer as they may crack when frozen.
- The refrigeration system behind and inside the refrigerator contains refrigerant. If this system is punctured it could result in serious damage to your refrigerator, therefore do not allow any sharp objects to come into contact with the refrigeration system.
- In case of gas leak, ventilate the area by opening a window, etc. Do not touch the refrigerator or the power outlet.
- Do not place objects containing liquid or unsteady objects on top of refrigerator.
- This refrigerator is not intended for use by persons (including children) with reduced physical, sensory or mental capabilities, or lack of experience and knowledge, unless they have been given supervision or instruction concerning use of the refrigerator by a person responsible for their safety. Young children should be supervised to ensure that they do not play with the refrigerator.

INSTALLATION

WARNING

- Do not install the refrigerator in a damp or wet location as this may cause damage to the insulation. Condensation may also build on the outer cabinet and cause rust.

- 1 Keep adequate ventilation space around the refrigerator.
 - The figure shows the minimum required space for installing the refrigerator. The amount of space around the refrigerator affects the amount of power consumption.
 - Insufficient spacing will decrease cooling efficiency and increase energy consumption. This may reduce the life of the unit and void warranty.

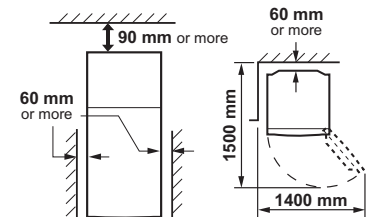

- 2 Using the two front adjustable feet, ensure that the refrigerator is positioned firmly and level on the floor.
- 3 Remove the 2 screws of the cabinet lower part, and use these to fit the foot covers. (supplied inside the refrigerator compartment)

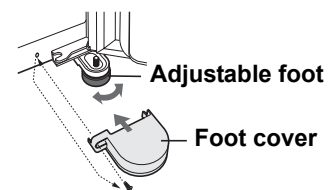

- 4 Connect the power plug to a 230/240 volt. 10 amp. power point.

NOTE

- Position your refrigerator so that the plug is accessible.
- Keep your refrigerator out of direct sunlight.
- Do not place next to a heat generating appliance.
- This refrigerator is designed for indoor use only, do not place the unit on an unsealed surface.

When transporting

- Using the casters, it is possible to move back and forth.
- Carry the refrigerator by holding the handles located on the rear and bottom.

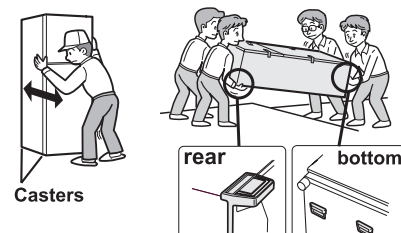

Before using your refrigerator

Clean the inside parts with a cloth soaked in warm water. If soapy water is used, wipe it off thoroughly with water.

DESCRIPTION

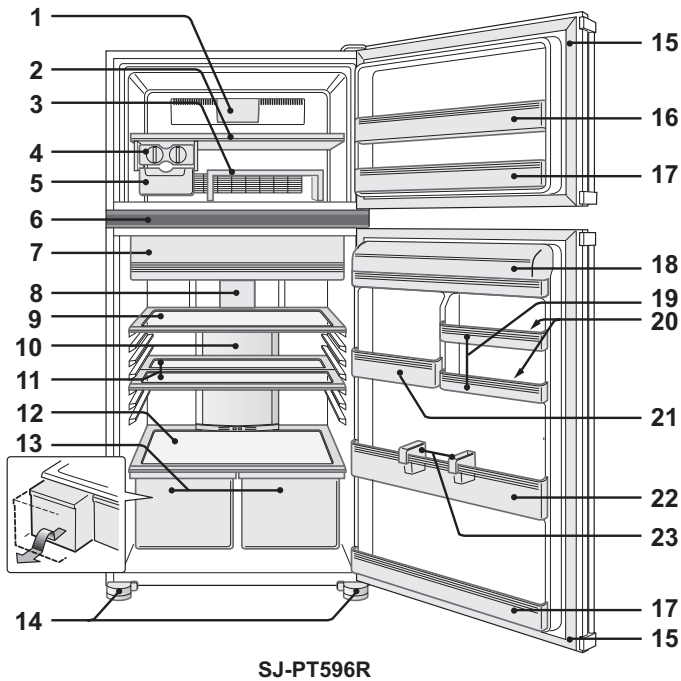

SJ-PT596R

1. Freezer LED light
2. Freezer shelf
3. Movable shelf
4. Ice cube maker
5. Ice cube box
6. Control panel
7. Fresh case & door
8. Refrigerator LED light
9. Refrigerator shelf
10. Hybrid cooling panel (Aluminium panel)
11. Half shelf (1 pair)
12. Fruit and vegetable shelf
13. Fruit and vegetable crisper
14. Adjustable feet & cover
15. Magnetic door seal
16. Flexible pocket
17. Door pocket
18. Refrigerator pocket & cover
19. Utility pocket
20. Egg holder
21. Utility pocket (large)
(Only for SJ-PT596R)
22. Bottle pocket
23. Tube stand

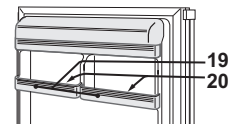

SJ-PT555R

NOTE (Only for SJ-PT596R)

Do not replace the right and left position of the utility pocket and the utility pocket (large).

Hints when making ice

- 1 Do not over fill the Ice cube trays; otherwise the ice cubes will be joined together when frozen.
- 2 When the ice cubes are made, turn the lever clockwise to empty the ice into the Ice cube box.

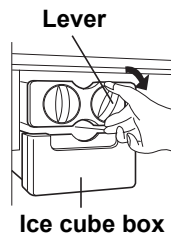

Ice cube box

NOTE

To prevent damage to the Ice cube box, do not make ice in the Ice cube box.

Flexible pocket

Tall food items (e.g. pizza box) can be stored by lifting the partition from the bottom of the pocket.

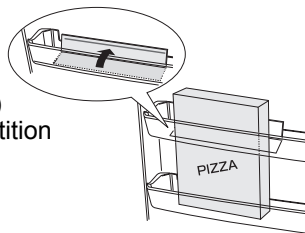

Movable shelf

Enables you to store food separately. If used upside down, you can keep foods neatly within this shelf.

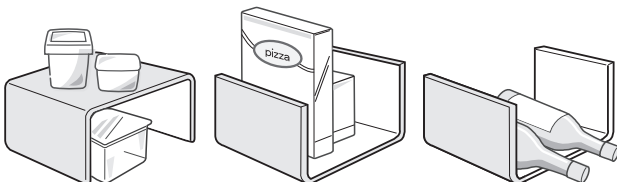

(In the refrigerator compartment)

Hybrid cooling panel (Aluminium panel)

The panel is cooled from the rear, thus indirectly cooling the refrigerator compartment. In this way, food is refrigerated gently, without exposing it to cold air flow.

Half shelf

The position of the shelf can be arranged according to the size of the food items to be stored.

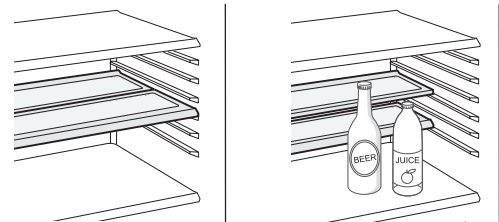

Tube stand

Prevents bottles etc. from falling. Tube-type food products can also be stored inside.

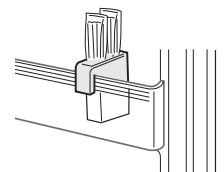

Deodorising unit

A deodorising catalyst is installed on the routes of cold air. No operation and cleaning required.

Reversible door

The door can be modified to open from the left with an optional twin kit SJ-L55CRD. For details of the kit and modification work, please contact a SHARP approved service centre.

CAUTION SHARP recommends that all modification work and a quote are carried out by a competent person.

OPERATION

Control panel

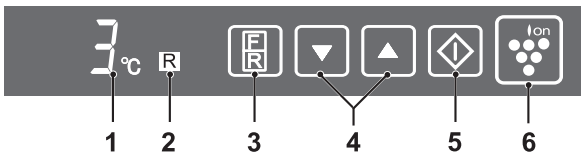

1. Display for temperature setting

The preset temperature of compartment selected is displayed. It is not the actual temperature in the compartment.

2. Display for compartment selected

3. Select button

The compartment selected can be changed by pressing the select button.

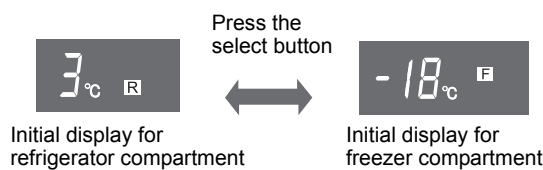

4. ▼/▲ button

Use to select temperature.

5. ◆ button

Finalises the temperature setting.

6. Plasmacluster button and display

Press to start / cancel the plasmacluster operation.

NOTE

- The display for temperature setting and selected compartment will turn off when there is no operation for 1 minute. (When either button is pressed, it lights again.)
- The plasmacluster display stays alight while ever the operation is selected.

Plasmacluster

The plasmacluster automatically starts operating when the refrigerator is powered on.

To cancel operation

Press the "Ion" button (The light turns off).



To start operation

Press the "Ion" button again.

Notes about PLASMACLUSTER operation

The ioniser inside your refrigerator releases clusters of ions, which are collective masses of positive and negative ions, into the freezer and refrigerator compartments. These ion clusters help to inactivate airborne mold fungus.

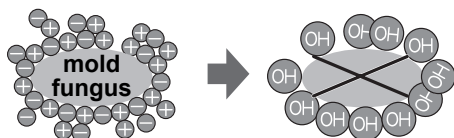

- There may be a slight odors in the refrigerator. This is the smell of ozone generated by the ionizer. The amount of ozone is minimal, and quickly decomposes in the refrigerator.

Controlling temperature

The refrigerator controls its temperature automatically. However, if needed, adjust the temperature as follows.

Refrigerator compartment

Adjustable between 0°C and 6°C in steps of 1°C.

1 Press the select button.

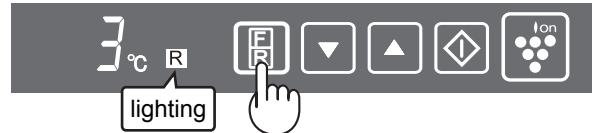

2 Press the ▲/▼ button and set the temperature. [▲: increase, ▼: decrease]



3 Press the "◆" button to finalise the setting.



Freezer compartment

Adjustable between -13°C and -21°C in steps of 1°C.

1 Press the select button.

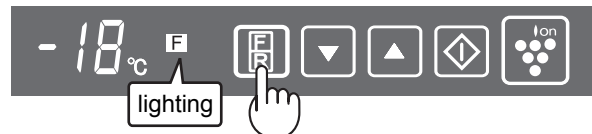

2 Press the ▲/▼ button and set the temperature. [▲: increase, ▼: decrease]



3 Press the "◆" button to finalise the setting.



Door Alarm

When the refrigerator or freezer door is left open, the door alarm will sound.

- The door alarm will sound 1 minute after opening the door and again after 1 minute (once in each case).
- If the door is left open for approx. 3 minutes, the alarm will sound continuously.

To cancel alarm signal

Press the select button continuously for 3 seconds or more while holding down the "◆" button.

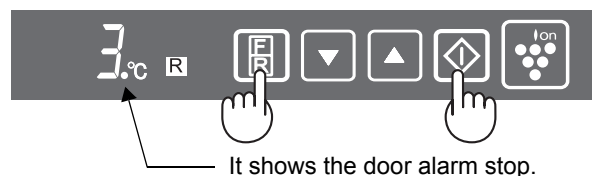

Use the same method to restart the alarm signal function.

STORING FOOD

Refrigeration reduces the rate of food spoilage. To maximise the shelf life of perishable food products, ensure that the food is the freshest possible quality. The following is a general guide to help promote longer food storage.

Fruit / Vegetables

To minimise moisture loss, fruit and vegetables should be loosely enclosed in a plastic material (e.g. wrap, bags) and placed in the fruit and vegetable crisper.

Dairy Products & Eggs

- Most dairy products have a use by date on the outer packaging which informs the recommended temperature and shelf life of the product.
- Eggs should be stored in the Egg holder.

Meats / Fish / Poultry

- Place on a plate or dish and cover with paper or plastic wrap.
- For larger cuts of meat, fish, or poultry, place to the rear of the shelves.
- Ensure all cooked food is wrapped securely or placed in an airtight container.

NOTE

- Evenly place the food on the shelves to allow the cooling air to circulate efficiently.
- Hot foods should be cooled before storing. Storing hot foods increases the temperature in the unit and increases the risk of food spoilage.
- Do not block the outlet and inlet of the cool air circulating system with foods or containers; otherwise the foods will not be evenly cooled throughout the refrigerator.
- Keep the door securely closed.

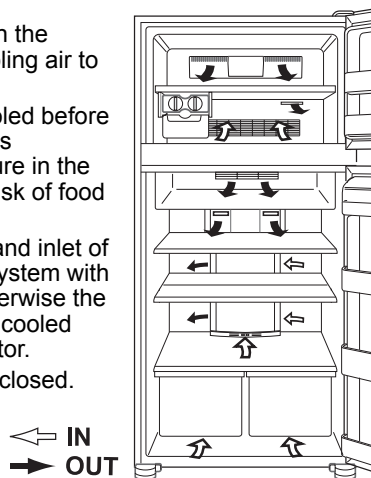

Do not place food directly in front of cold air outlet. This may lead to the food freezing.

For best freezing

- Quality of foods should be fresh.
- Freeze small quantities of food at a time to freeze them quickly.
- Food should be properly stored or covered and the air should be removed to seal tightly.
- Evenly place the food in the freezer.
- Label bags or containers to keep an inventory of freezing food.

CARE AND CLEANING

WARNING

- Unplug the refrigerator first to prevent electric shock.
- Do not splash water directly on the outer cabinet or the interior. This may lead to rusting and deterioration of the electrical insulation.

IMPORTANT

To prevent cracking on inside surfaces and plastic components, follow these tips.

- Wipe any food oils adhered to plastic components.
- Some household chemicals may cause damage, so use only diluted washing-up liquid (soapy water).
- If undiluted detergent is used or soapy water is not wiped off thoroughly, cracking of plastic parts can result.
- Wipe any spills from the refrigerator immediately, acid or alkaline in the food can cause cracking and staining of plastic parts.

- 1 Remove the shelves and pockets from the cabinet and door. Wash them in warm soapy dishwashing water; rinse in clean water and dry. (Only fruit and vegetable shelf is not removable.)
- 2 Clean the inside with a cloth soaked in warm soapy dishwashing water. Then, use cold water to wipe off soapy water.
- 3 Wipe the exterior with a soft cloth each time it is soiled.
- 4 Clean the Magnetic door seal with a toothbrush and warm soapy dishwashing water.
- 5 Wipe the control panel with the dry cloth.

NOTE

- Do not use hot water, household cleaning powders, creams or spray on cleaning products, or any other cleaning products such as mineral turpentine, methylated spirits, thinners, petrol etc. These may damage your refrigerator and may void any warranty.
- If the power supply is disconnected, please wait for at least 5 minutes before re-connecting power.
- The glass shelves weigh approximately 3 kg each. Hold firmly when removing from the cabinet or carrying.
- Wipe any spills from the control panel immediately, liquid ingress can damage the electronics.
- Do not drop objects inside the refrigerator or strike the inner wall. This may cause the inner surface to crack.

Defrosting

Defrosting is fully automatic due to a unique energy saving system.

If a refrigerator lamp blows

The lamp should only be replaced by a SHARP approved service centre.

Switching off your refrigerator

If the refrigerator needs to be switched off for an extended period, the following steps should be taken to reduce the symptom of mold:

1. Remove all food.
2. Remove the power plug from the power point.
3. Clean and dry the interior thoroughly.
4. Ensure that all the doors are wedged open slightly for air circulation.

WHAT TO DO BEFORE CALLING FOR SERVICE

Before you call for service, check the following points.

Problem	Solution
The outside of cabinet is hot when touched.	This is normal. The hot pipe is in the cabinet in order to prevent dew generation.
When there is refrigerator noise.	It is normal for the refrigerator to produce the following sounds. <ul style="list-style-type: none"> • Loud noise produced by the compressor when operation starts --- Sound becomes quieter after a while. • Loud noise produced once a day by the compressor --- Operating sound produced immediately after automatic defrost operation. • Sound of flowing fluid (gurgling sound, fizzing sound) --- Sound of refrigerant flowing in pipes (sound may become louder from time to time). • Cracking or crunching sound, squeaking sound --- Sound produced by expansion and contraction of inner walls and internal parts during cooling.
Frosting or dew generation occurs inside or outside the refrigerator.	This may occur in one of the following cases. Use a wet cloth for wiping frost and a dry cloth for wiping dew. <ul style="list-style-type: none"> • When the ambient humidity is high. • When the door is frequently opened and closed. • When foods containing plenty of moisture are stored. (Wrapping is required.)
The food in the refrigerator compartment freeze.	<ul style="list-style-type: none"> • Is the refrigerator operated for a long time with refrigerator temp. control set at 0°C? • Is the refrigerator operated for a long time with freezer temp. control set at -21°C? • Low ambient temperature may cause foods to freeze even if refrigerator temp. control is set to 6°C.
Noticeable odours.	<ul style="list-style-type: none"> • Wrapping is required for foods with strong odours. • Deodorising unit cannot remove all odours.

If you still require service contact your SHARP approved service centre.

SHARP approved service centre locations can be found in the support area of our website:

Australia : <http://www.sharp.net.au>

New Zealand : <http://www.sharp.net.nz>

SPECIFICATION

		SJ-PT555R	SJ-PT596R
Rated voltage (V~)		230 - 240	
Rated frequency (Hz)		50	
Rated current (A)		0.53 - 0.54	
Rated input of heating systems (W)		160 - 174	
Defrosting input (W)		160 - 174	
Climate class		T	
Refrigerant		HFC - 134a	
Charge (g)		110	
Insulation blowing gas		Cyclo pentane	
Rated storage volume (L)		514	555
Rated gross volume (L)		555	596
Group (AS / NZS 4474.1)		5T	
Net weight (kg)		80	82
Outer dimensions (mm)	Height	1670	1770
	Width	800	800
	Depth (Including the handle)	720 (728)	720 (728)

- If further depth reduction is required for site access/installation, the doors and control panel can be removed to reduce the overall depth from 728 mm to 635 mm. Only a SHARP approved service centre can perform removal and replacement of the doors/control panel. The customer should obtain an estimate from a SHARP approved service centre prior to purchase.

SHARP

SHARP CORPORATION OF AUSTRALIA PTY.LTD.
A. B. N. 40 003 039 405

1 HUNTINGWOOD DRIVE, HUNTINGWOOD, N.S.W. 2148
P.O.BOX 6827, BLACKTOWN. N.S.W. 2148

SHARP CORPORATION OF NEW ZEALAND LIMITED
59 HUGO JOHNSTON DRIVE PENROSE, AUCKLAND

Printed in Thailand
TINS-A838CBZ 07LK (TH) ①

Free Manuals Download Website

<http://myh66.com>

<http://usermanuals.us>

<http://www.somanuals.com>

<http://www.4manuals.cc>

<http://www.manual-lib.com>

<http://www.404manual.com>

<http://www.luxmanual.com>

<http://aubethermostatmanual.com>

Golf course search by state

<http://golfingnear.com>

Email search by domain

<http://emailbydomain.com>

Auto manuals search

<http://auto.somanuals.com>

TV manuals search

<http://tv.somanuals.com>