

Features

For use with any 53000 SRT series garage door opener receiver.

Personalized Code: Up to 10,000 possible combinations. Code can easily be changed if desired.

Operation: Opener activates when 4-code digits and ENTER button are pressed.

The keypad will illuminate for 5 seconds at the first push of any key. If wrong numbers are accidentally pressed, correction can be made immediately. The ENTER key will transmit only the last four digits.

The keypad will blink for 15 seconds after the code is transmitted. During that time you can STOP or REVERSE door travel just by pressing the ENTER key.

The Lock feature on openers with premium door controls, is designed to prevent operation of the door from portable transmitters. However, the door will *open and close* from the door control push button and the Multi-Function Keyless Entry.

Power Supply: 9 Volt battery.

Programming the Code

We recommend that you program your personal code now, before you install the Multi-Function Keyless Entry. Then you can test the reception at the mounting location before you proceed further.

1. Lift the cover to access the keypad, Figure 1. Decide on a 4-digit code using numbers from 0 to 9. You can use a number more than once (for example, 4, 0, 4, 1).
2. Press the selected code digits on the keypad; then press and HOLD the ENTER button, and press the SRT button on the opener end panel (behind the Control Center for screwdrive), Figure 2.
3. Depending on your opener model, when you press the SRT button either the opener light(s) will flash or the garage door will begin to move. Release the ENTER button.

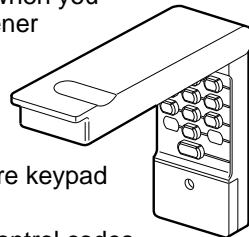

Figure 1

The opener has now learned the selected code and will respond to future keypad commands.

To ensure that your portable remote control codes were not disturbed while you were programming the Keyless Entry, test your remotes and reprogram them if necessary.

To change the code in your Keyless Entry at any time, repeat Steps 1-3.

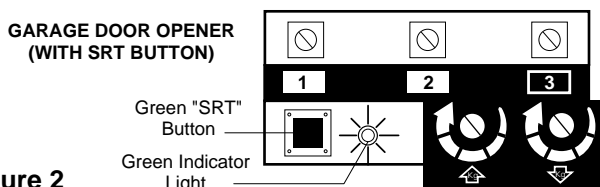

Figure 2

To comply with FCC rules, adjustment or modification of receiver and/or transmitter is prohibited, except for changing the code setting and replacing the transmitter battery. THERE ARE NO OTHER USER SERVICEABLE PARTS.



WARNING

Children operating or playing with a garage door opener can injure themselves or others. The garage door could close and cause serious injury or death. Do not allow children to operate the door push button(s) or remote control(s).

A moving garage door could injure or kill someone under it. Activate the opener only when you can see the door clearly, it is free of obstructions, and is properly adjusted.

Installation

The recommended mounting locations for sectional and one-piece doors are shown in Figure 3. You can select another location if you prefer. However, the keypad *must* be installed within sight of the door.

For a one-piece door, use the optional location shown in the illustration (on the edge of the door jamb) to avoid injury as the door swings up and out.

Test the reception of the Keyless Entry by operating your opener from the selected location. Change the location if necessary.

Open the keypad and remove the battery compartment screw and cover to access the bottom mounting hole (Figure 4).

Center the keypad at eye level against the selected location. Mark 4 1/4" up the centerline from the bottom and drill a 1/8" pilot hole. Install top mounting screw, allowing 1/8" to protrude above surface. Position keypad on screw head and adjust for snug fit.

With cover open so bottom mounting hole is visible, use a punch to mark hole. Remove keypad and drill 1/8" pilot hole. Replace keypad and complete installation with bottom screw, using care to avoid cracking plastic housing. Do not overtighten.

Replace the battery cover.

Battery: The 9 Volt battery should produce power for at least one year. Replace when keypad illumination becomes dim.

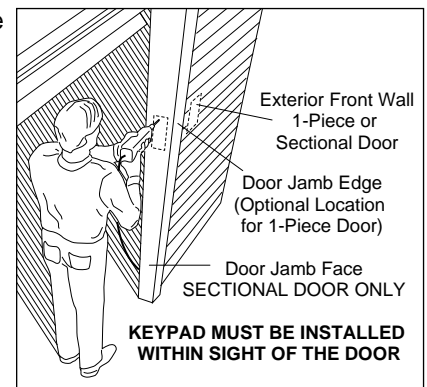

Figure 3

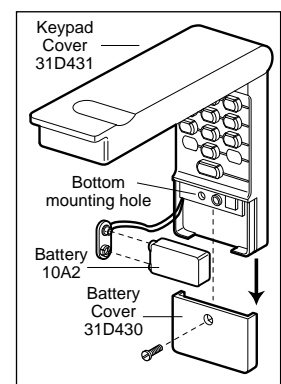

Figure 4

Free Manuals Download Website

<http://myh66.com>

<http://usermanuals.us>

<http://www.somanuals.com>

<http://www.4manuals.cc>

<http://www.manual-lib.com>

<http://www.404manual.com>

<http://www.luxmanual.com>

<http://aubethermostatmanual.com>

Golf course search by state

<http://golfingnear.com>

Email search by domain

<http://emailbydomain.com>

Auto manuals search

<http://auto.somanuals.com>

TV manuals search

<http://tv.somanuals.com>